



## **(ESD) ELECTRIC SLIDING DOOR**

**CITROEN JUMPER, DODGE PROMASTER,  
FIAT DUCATO, PEUGEOT BOXER  
2006-2020, FROM 2021**

(Operated either via vehicle's original remote's key,  
or the original handle of the sliding door)

**P.N.7486-1223**

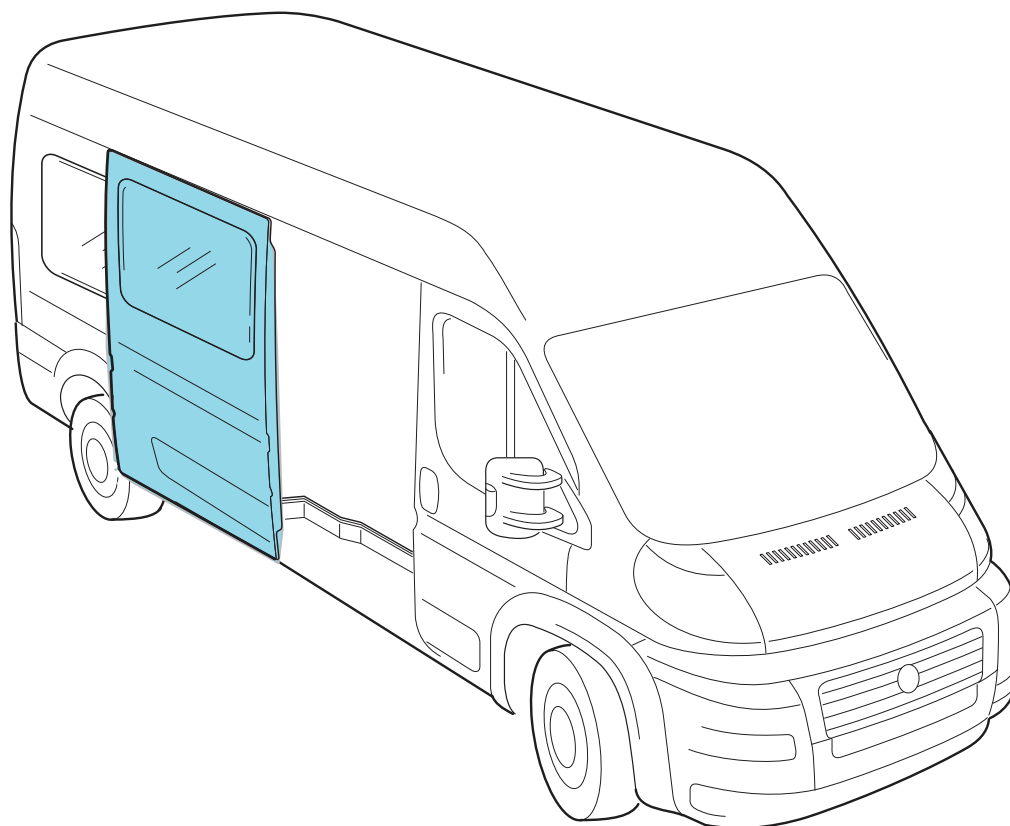

DUE TO UNANNOUNCED CHANGES IN THE VEHICLES, BEFORE ORDERING,  
KINDLY VERIFY THAT THE INSTALLATION DRAWINGS AND COMPONENTS ARE COMPATIBLE WITH THE SPECIFIC VEHICLE.  
ALEX ORIGINAL RESERVE THE RIGHT TO MAKE CHANGES IN ITS PRODUCTS WITHOUT ADVANCED NOTICE.

# ELECTRIC SLIDING DOOR

CITROEN JUMPER, DODGE PROMASTER, FIAT DUCATO, PEUGEOT BOXER  
2006-2020 / from 2021



## REQUIRED TOOLS

# ELECTRIC SLIDING DOOR

CITROEN JUMPER, DODGE PROMASTER, FIAT DUCATO, PEUGEOT BOXER  
2006-2020 / from 2021

PAGE 2

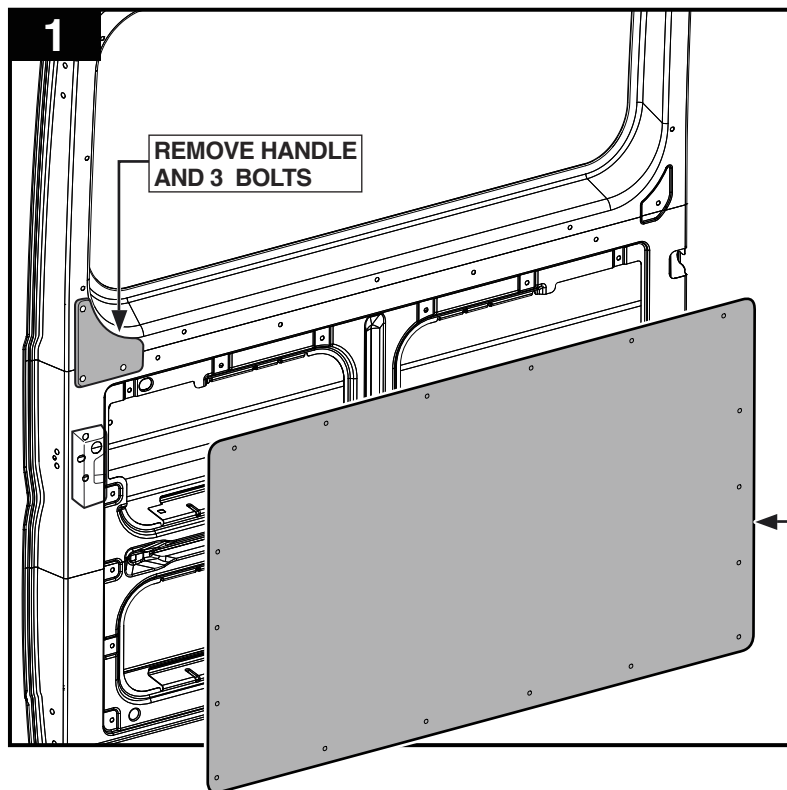

REMOVE COVER.  
RE INSTALL  
AFTER INSTALLING  
TO THE ACTUATOR ASSEMBLY

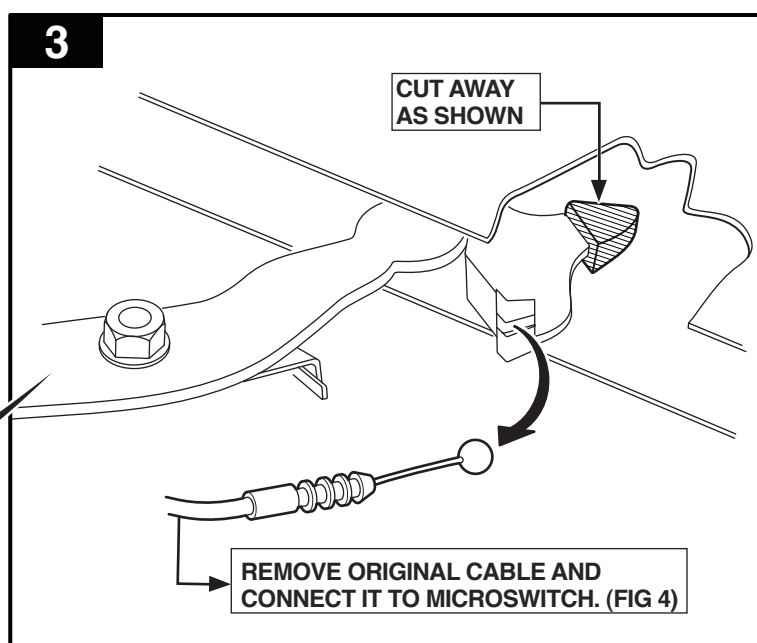
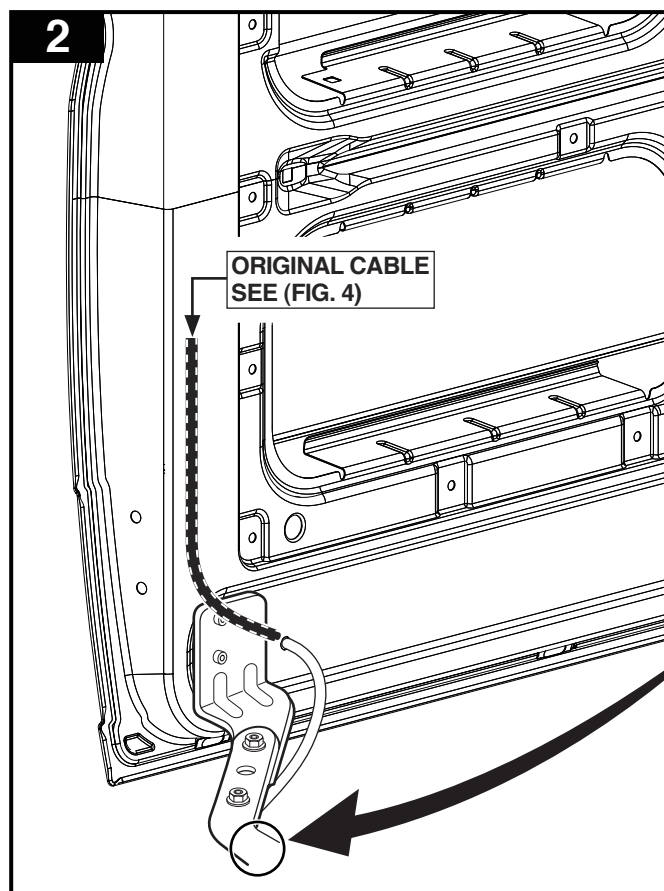
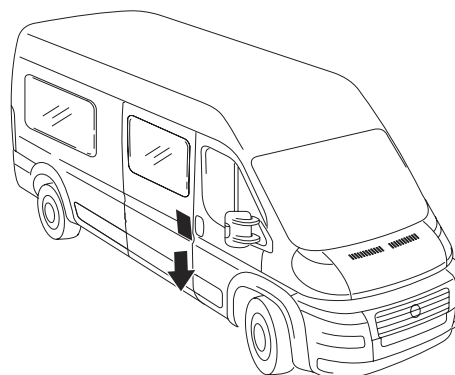
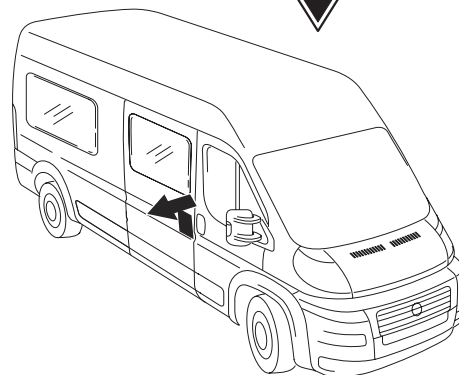

CITROEN JUMPER, DODGE PROMASTER, FIAT DUCATO, PEUGEOT BOXER  
2006-2020 / from 2021

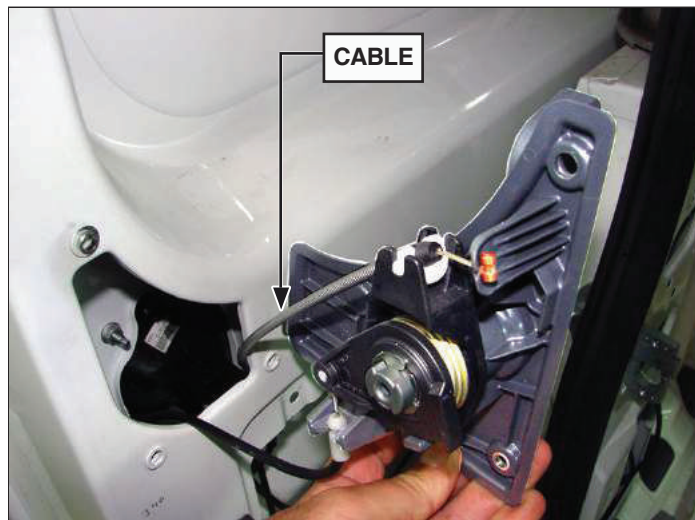

1. DISCONNECT ORIGINAL CABLE FROM INSIDE DOOR HANDLE.
2. CONNECT ORIGINAL CABLE TO ACTUATOR ASSY. POINT ②
3. CONNECT NEW CABLE P.N. (2032-277) TO ORIGINAL INSIDE DOOR HANDLE AND TO ACTUATOR ASSY. POINT ③
4. DISCONNECT ORIGINAL CABLE FROM LOWER DOOR ARM ( FIG. 2) AND CONNECT TO ACTUATOR ASSY. POINT ④

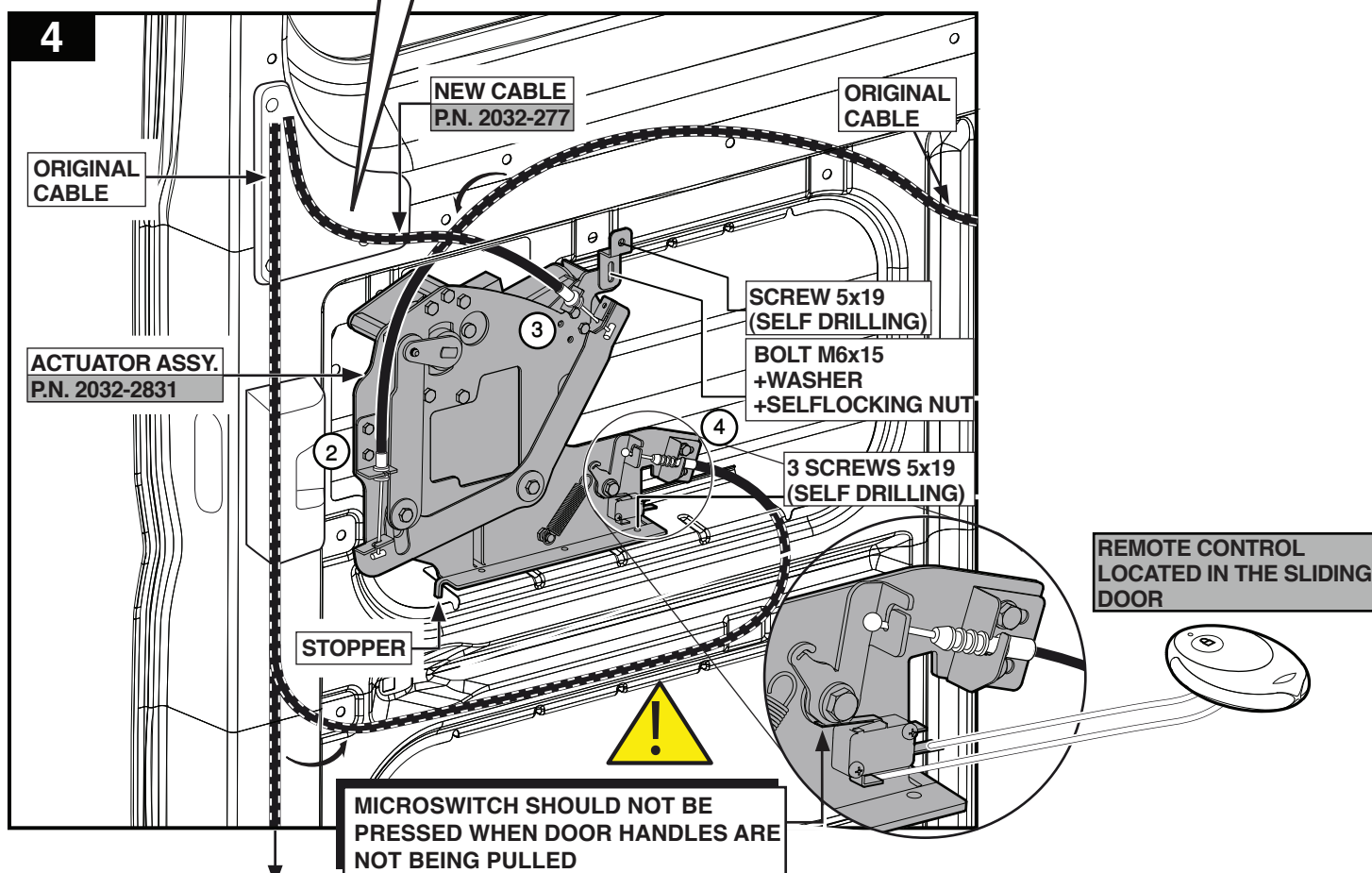

DISCONNECT ORIGINAL CABLE FROM LOWER DOOR ARM SEE (FIG. 2)



CABLE ADJUSTMENT ②,③,④

RELEASE 2 BOLTS AND AJDUST THE CABLE ACCORDING THE DRAWINGS

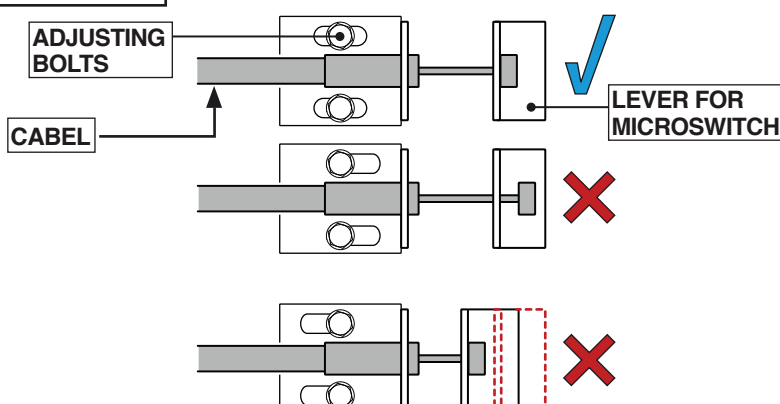



# ELECTRIC SLIDING DOOR

CITROEN JUMPER, DODGE PROMASTER, FIAT DUCATO, PEUGEOT BOXER  
2006-2020 / from 2021

PAGE 4

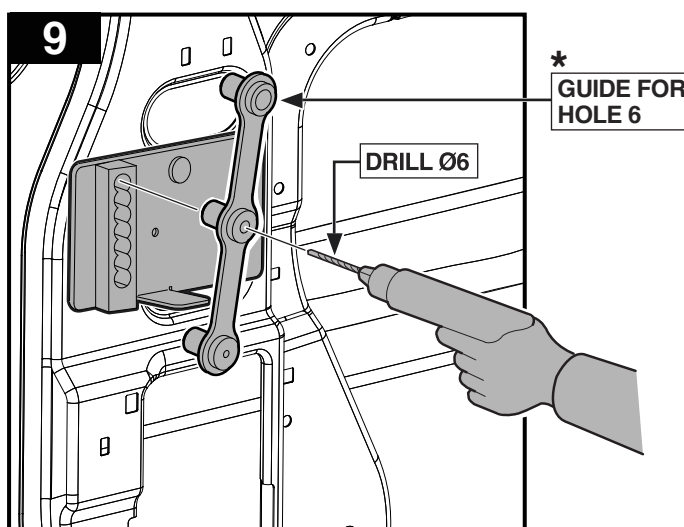
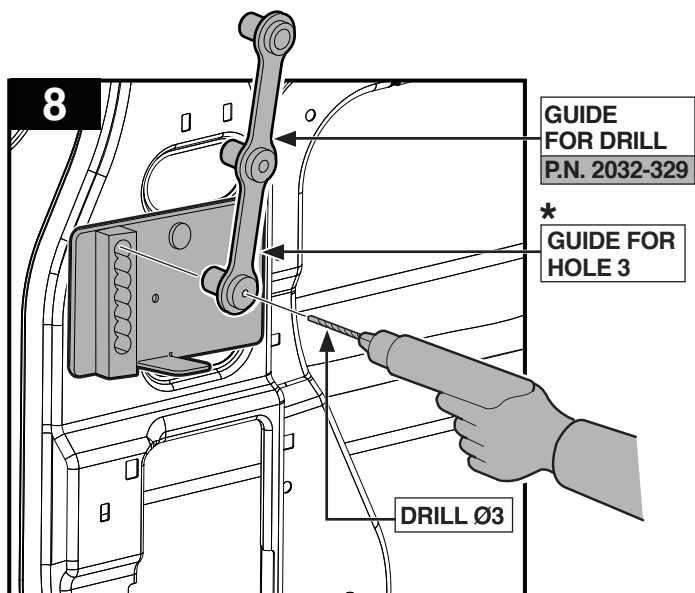
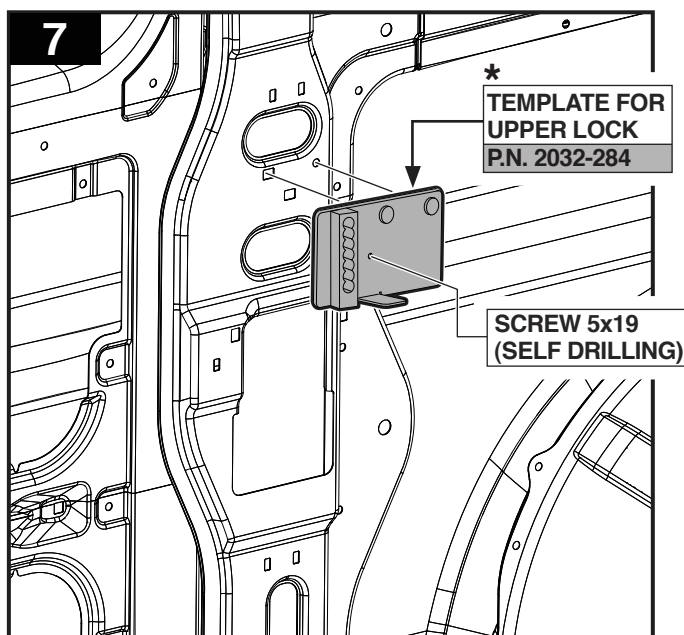
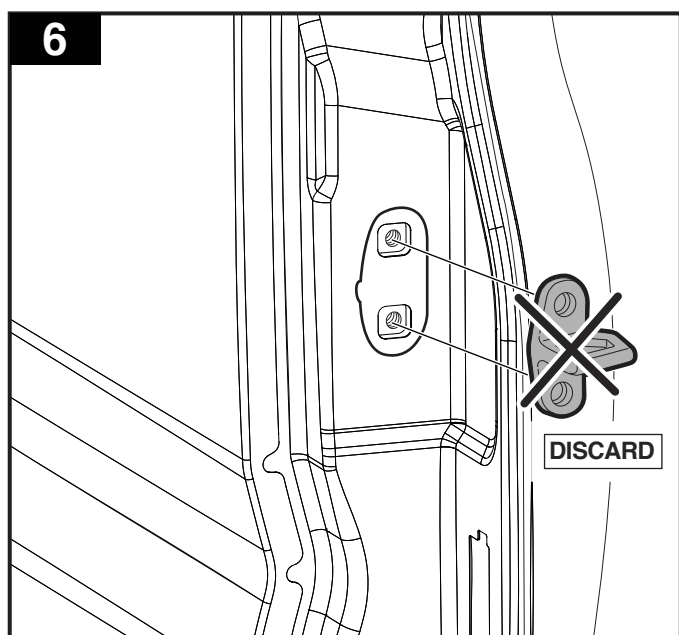
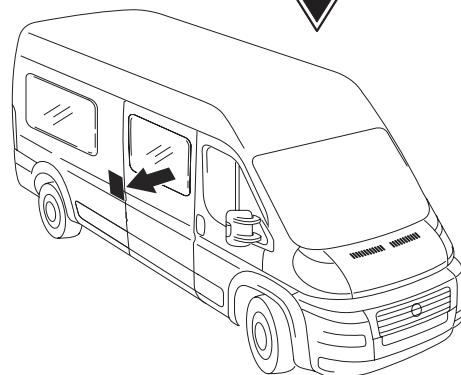
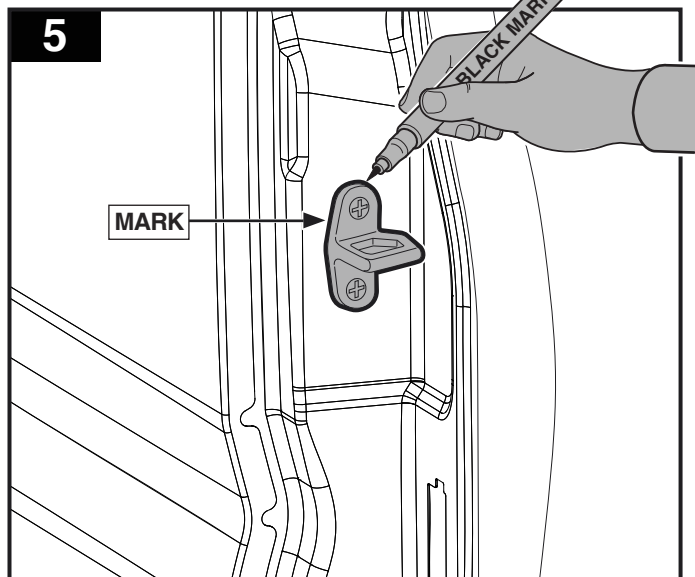

# ELECTRIC SLIDING DOOR

CITROEN JUMPER, DODGE PROMASTER, FIAT DUCATO, PEUGEOT BOXER  
2006-2020 / from 2021

PAGE 5

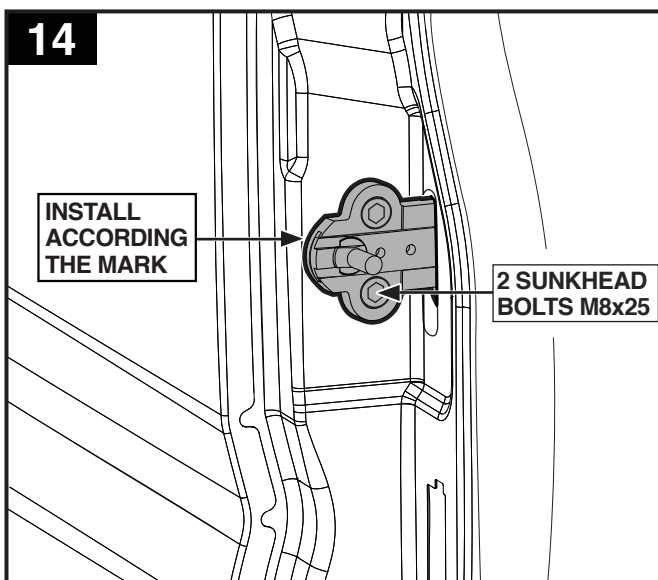
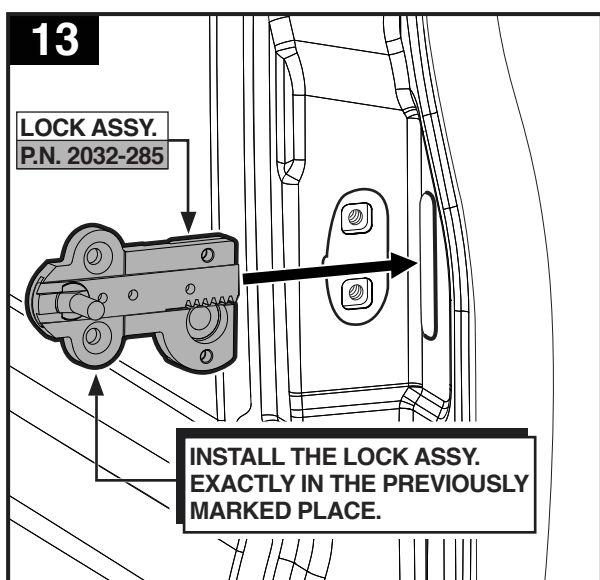
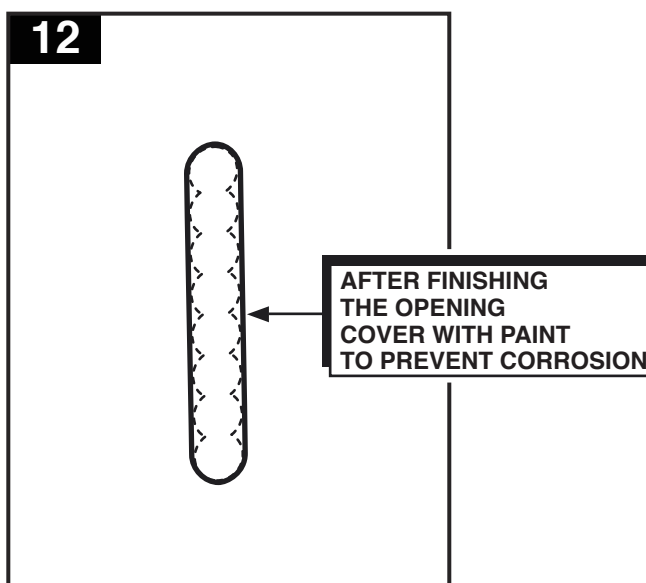
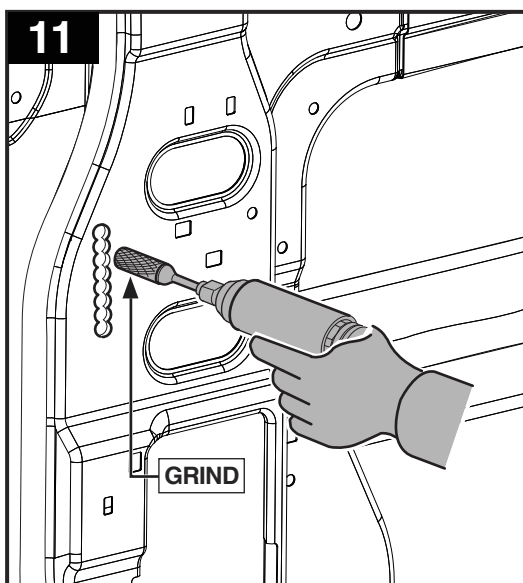
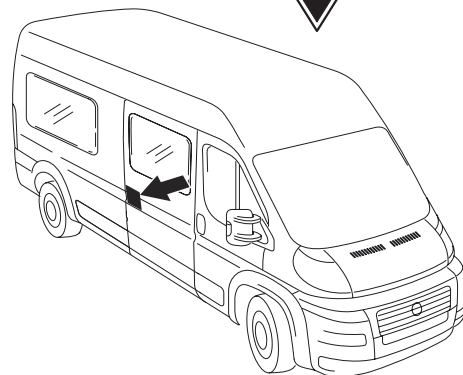
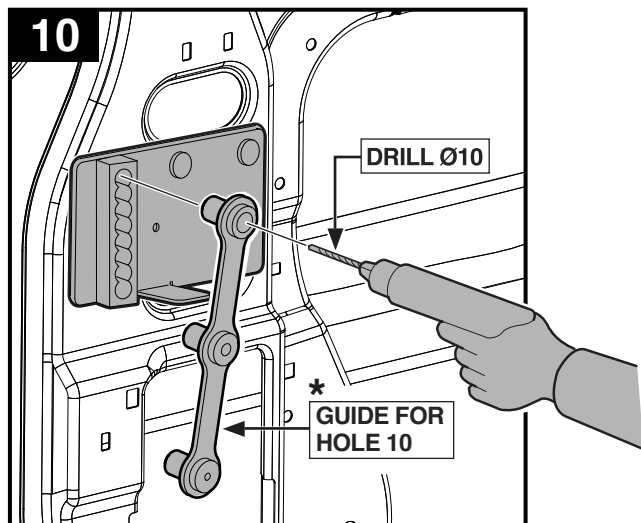

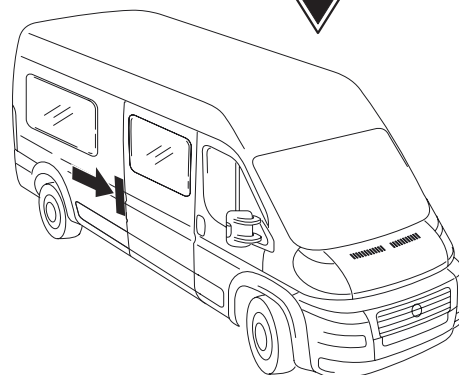
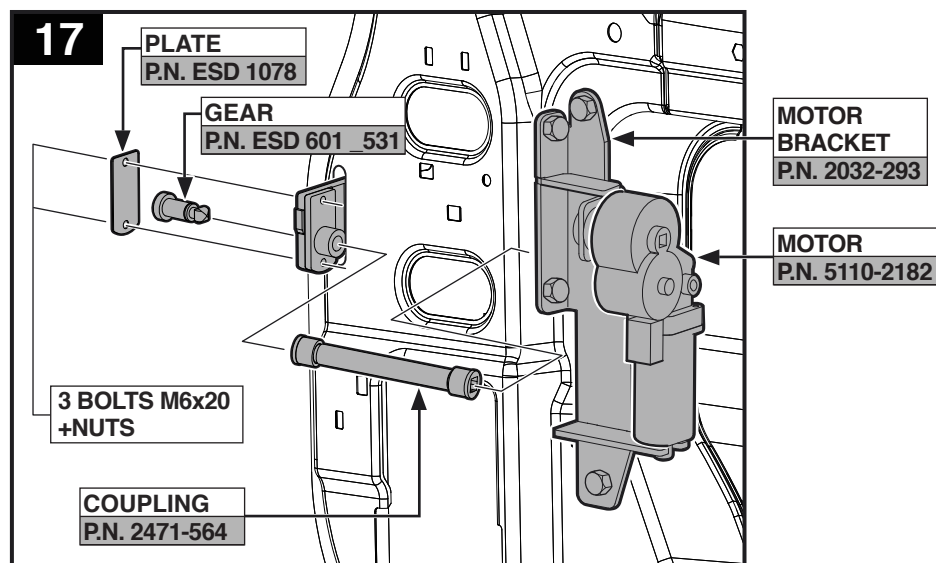
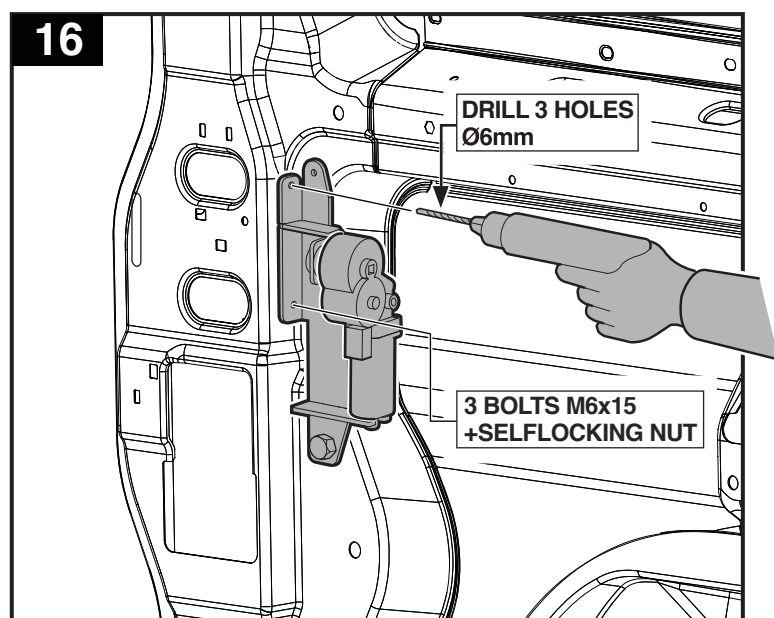
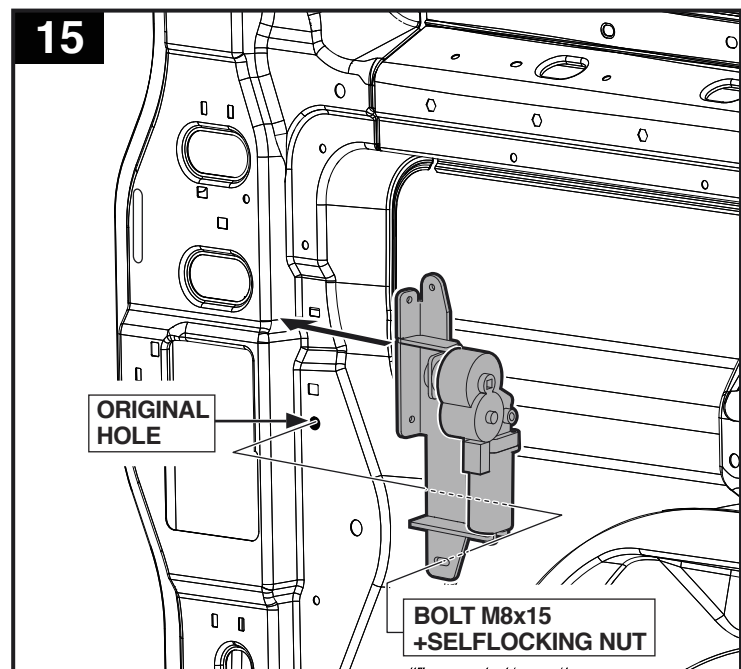

# ELECTRIC SLIDING DOOR

CITROEN JUMPER, DODGE PROMASTER, FIAT DUCATO, PEUGEOT BOXER  
2006-2020 / from 2021

PAGE 7



FOR HIGH ROOF ONLY

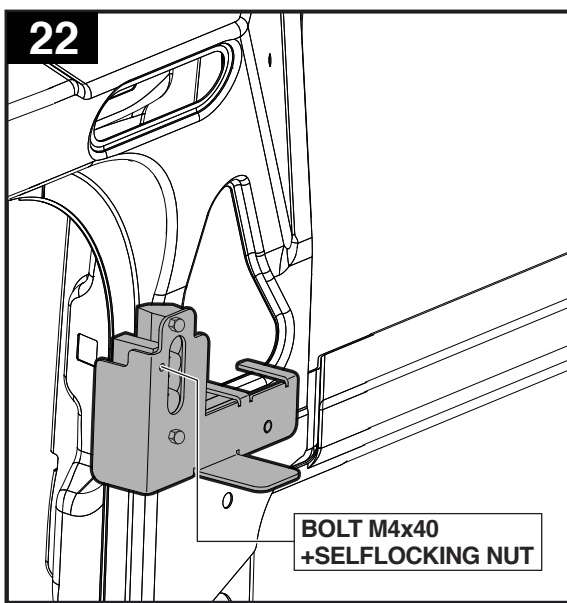
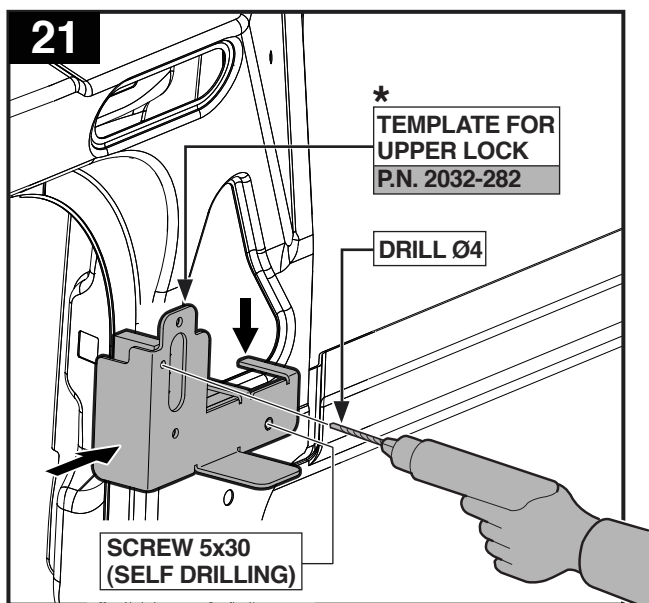
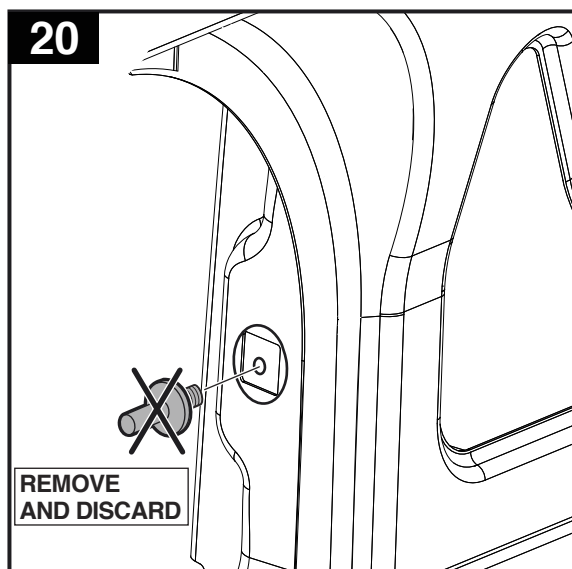
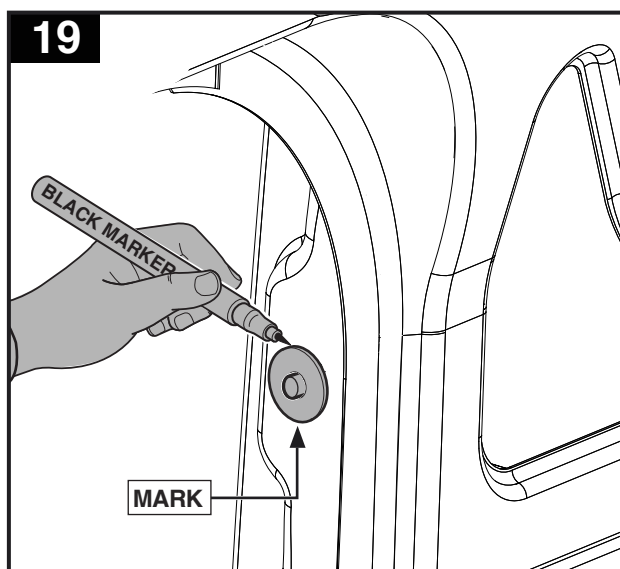
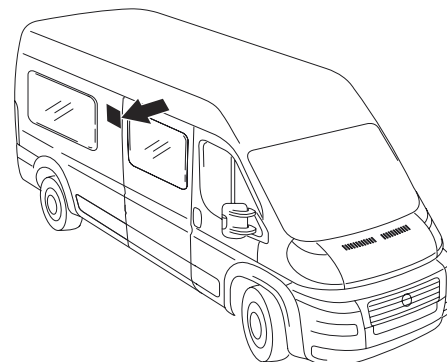
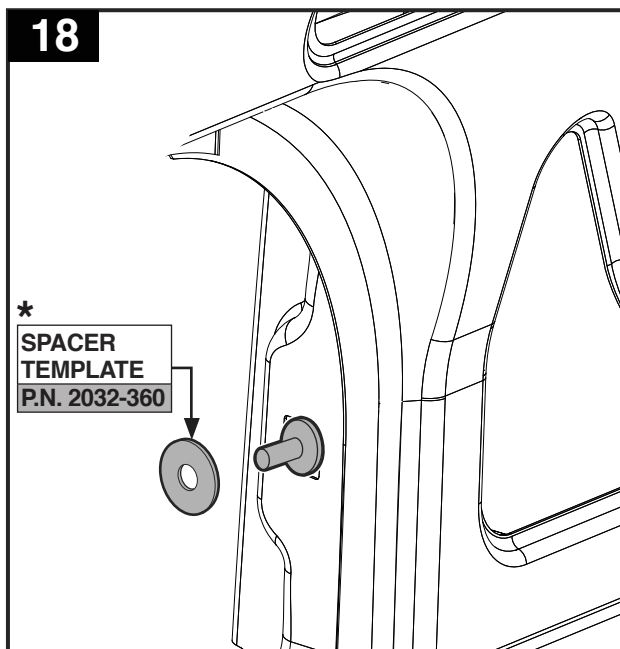

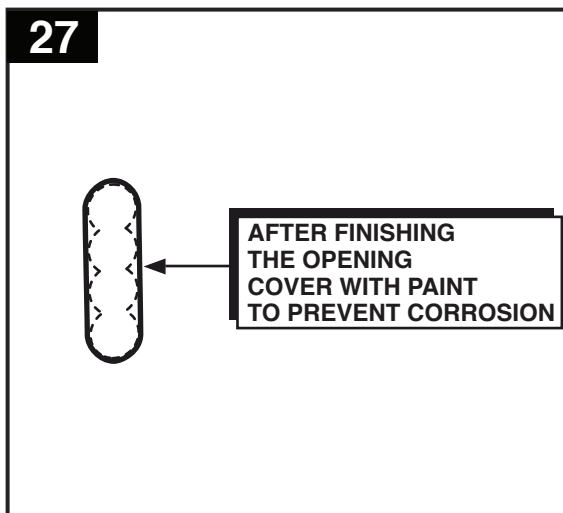
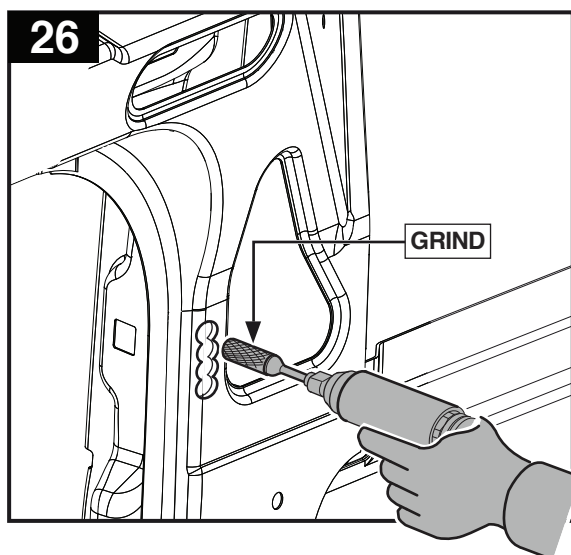
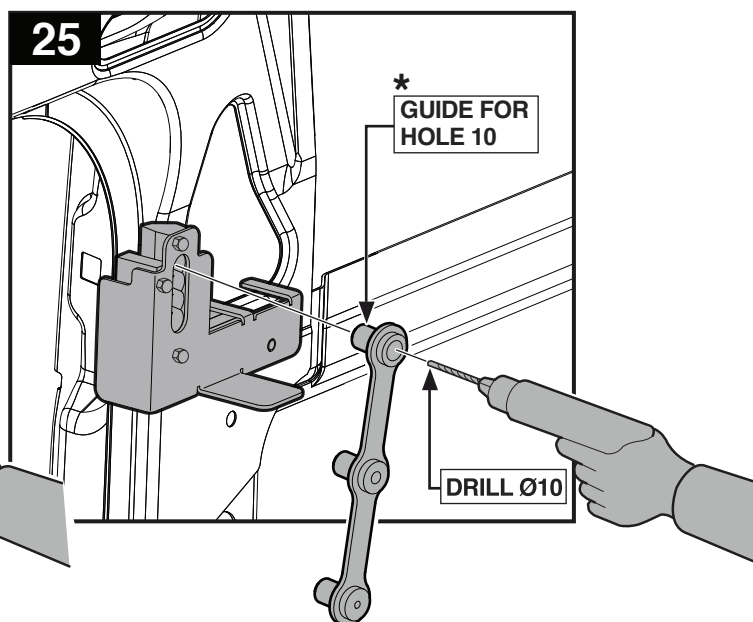
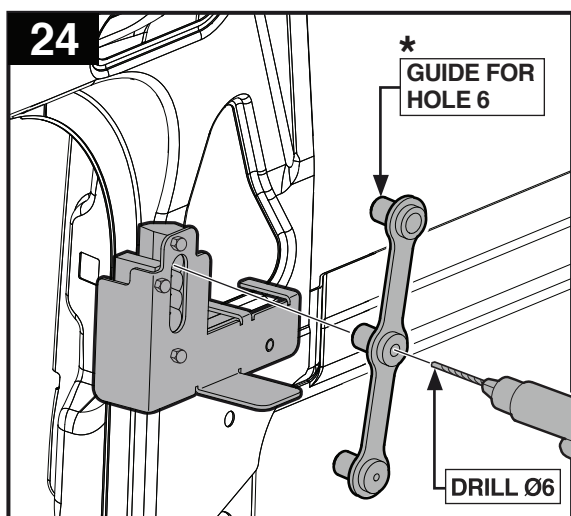
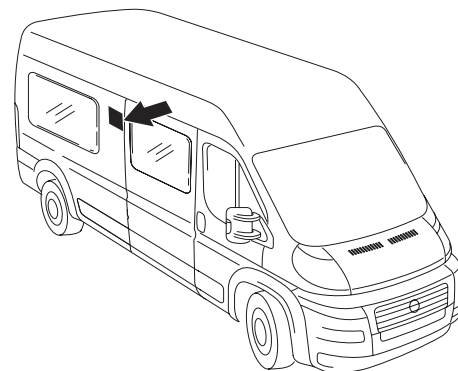
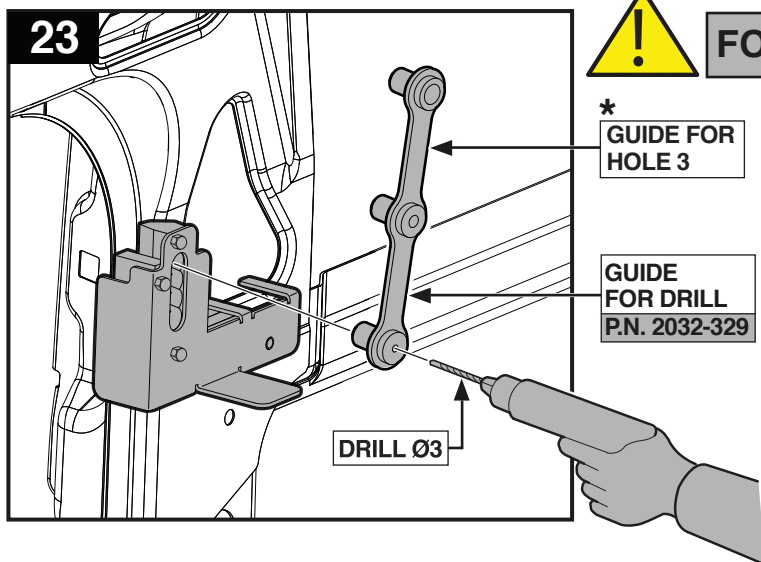



FOR HIGH ROOF ONLY

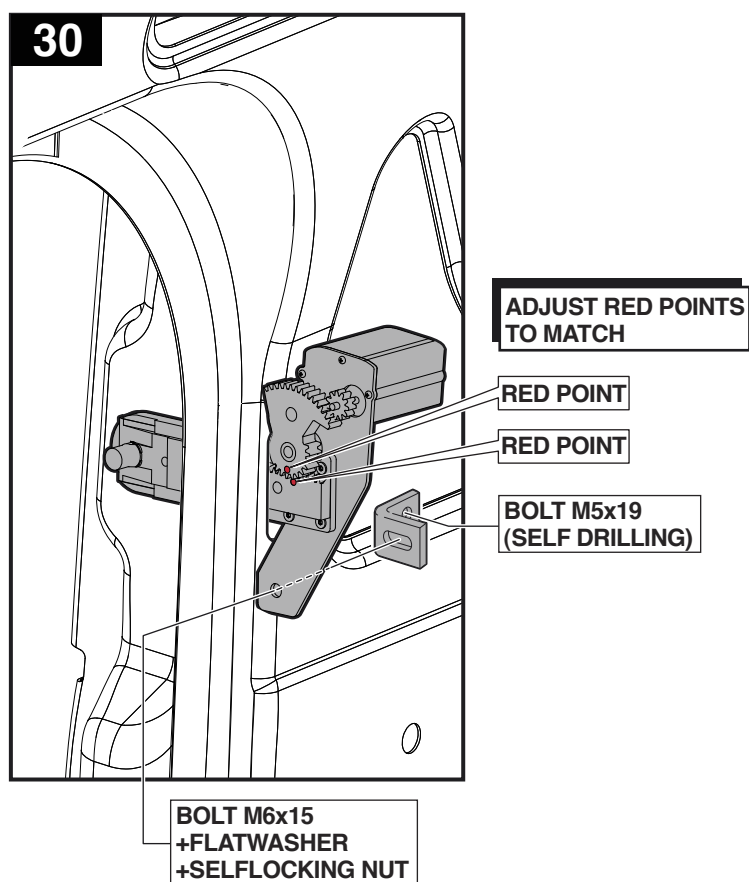
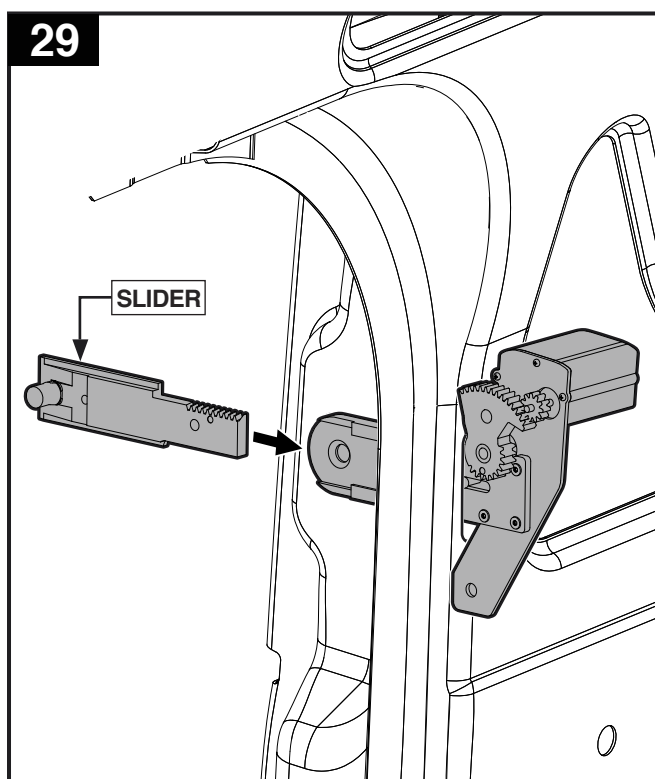
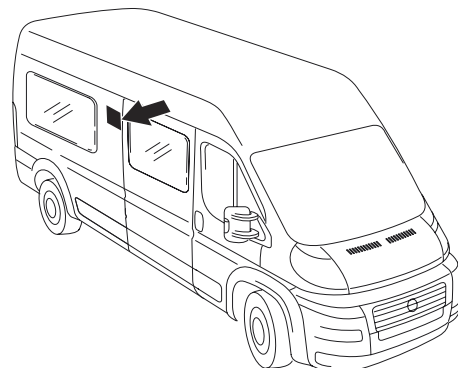
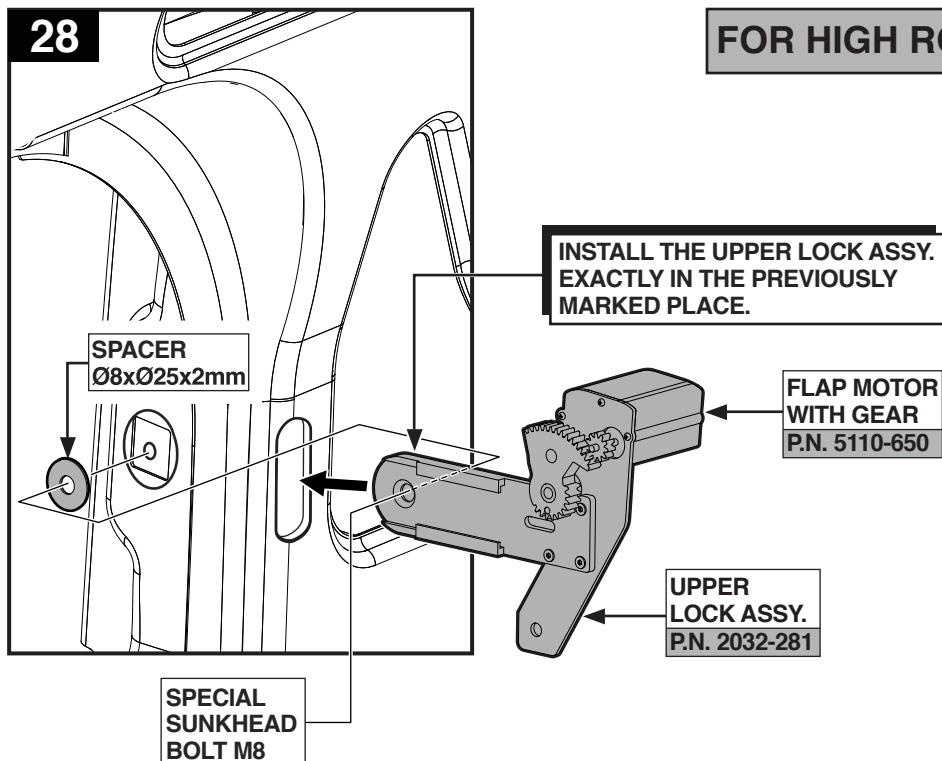



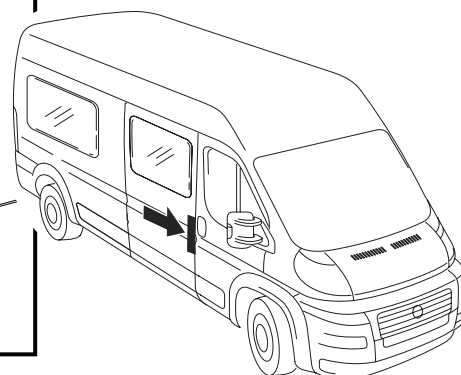
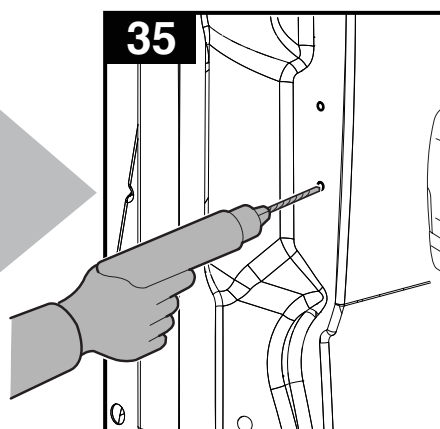
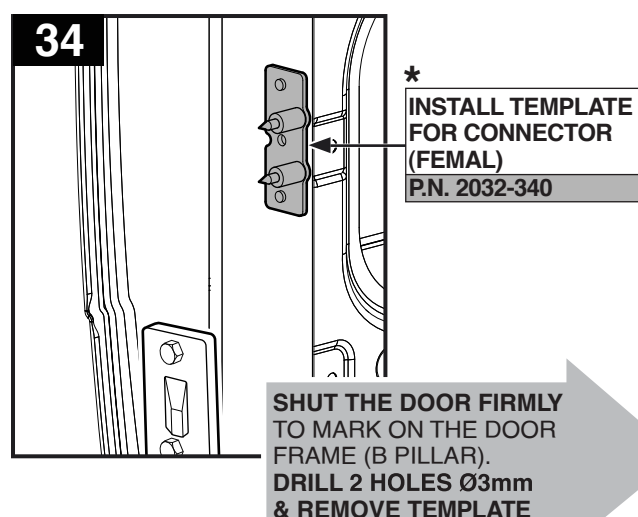
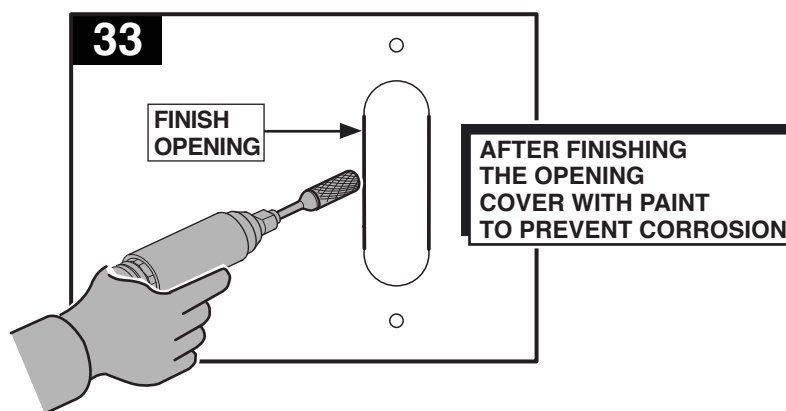
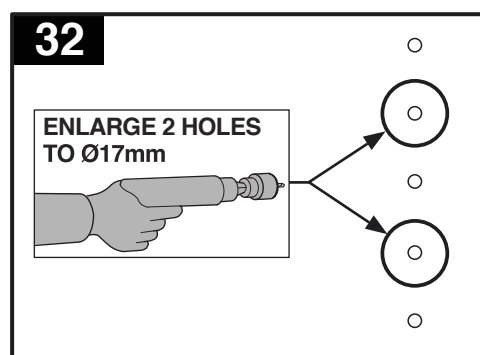
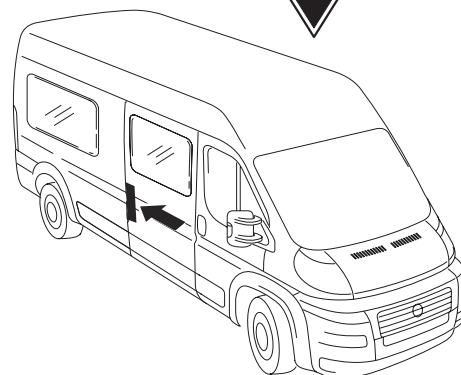
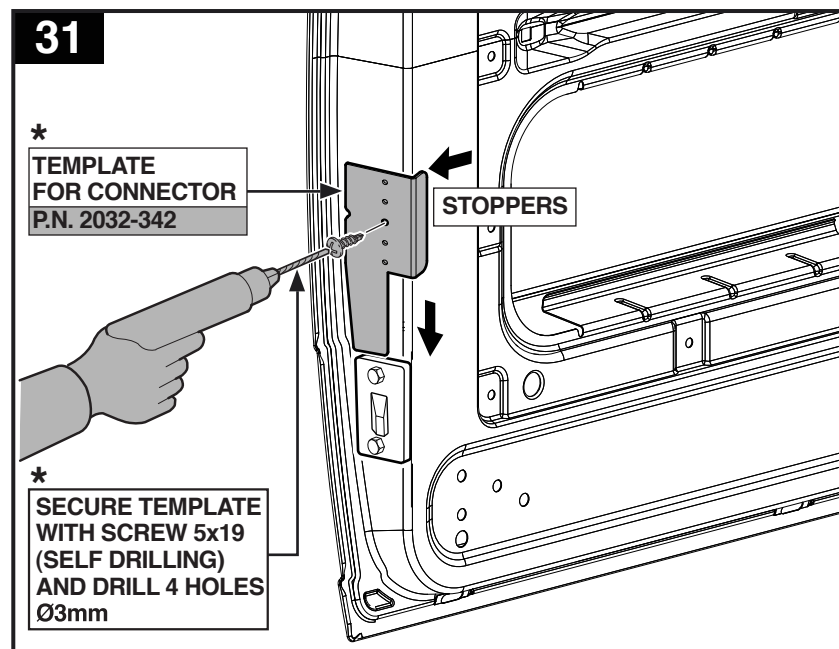

CITROEN JUMPER, DODGE PROMASTER, FIAT DUCATO, PEUGEOT BOXER  
2006-2020 / from 2021

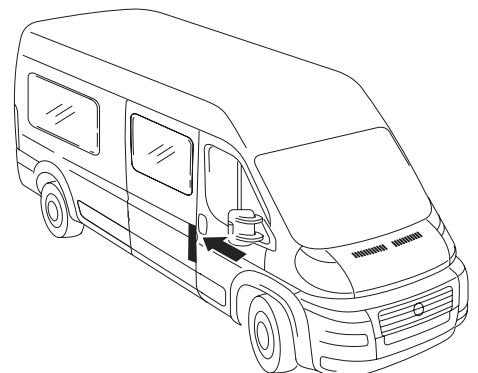
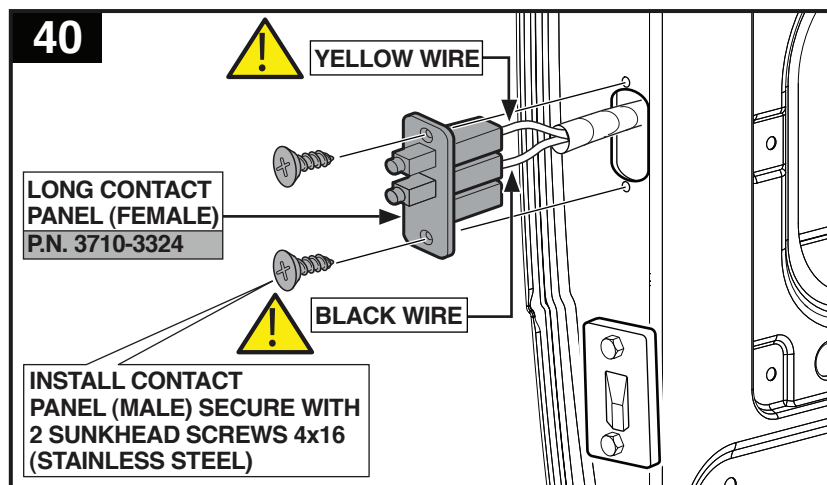
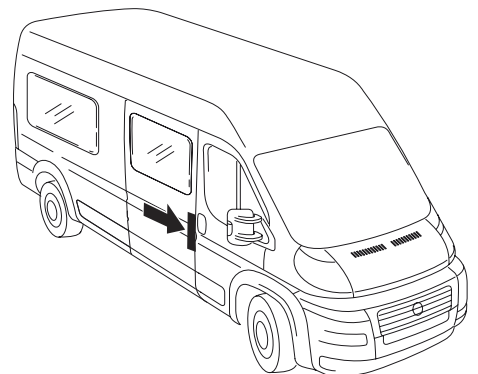
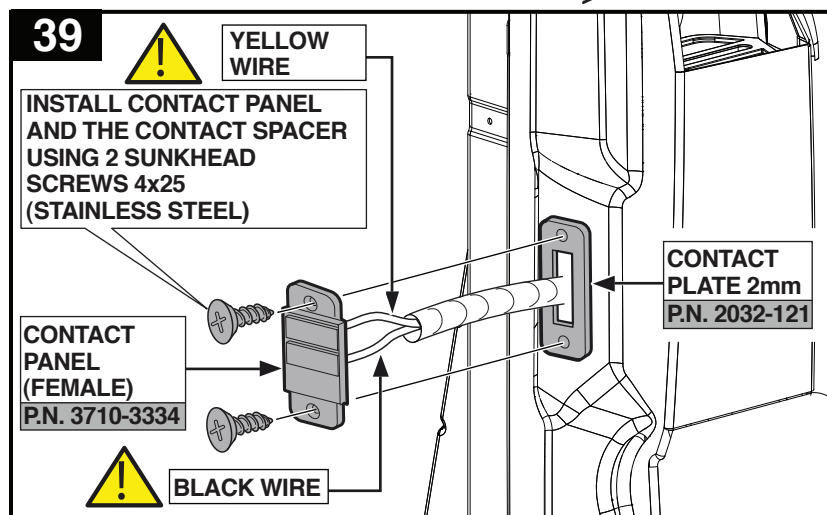
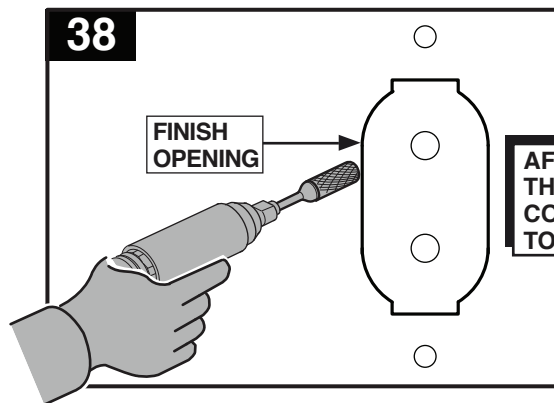
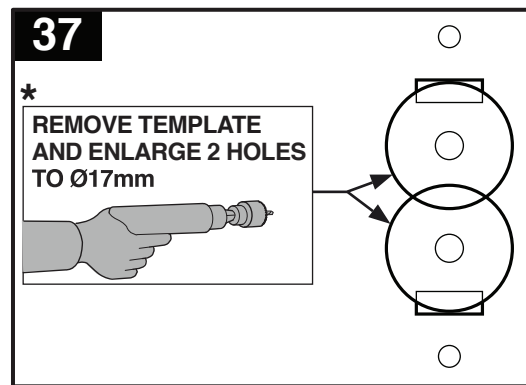
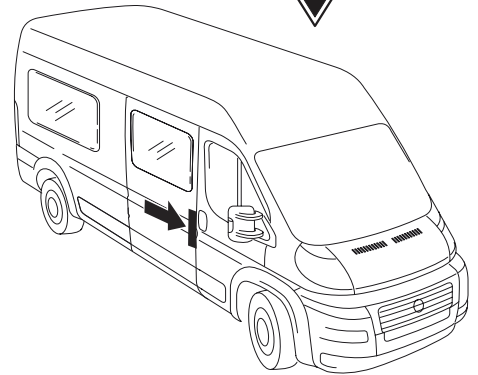
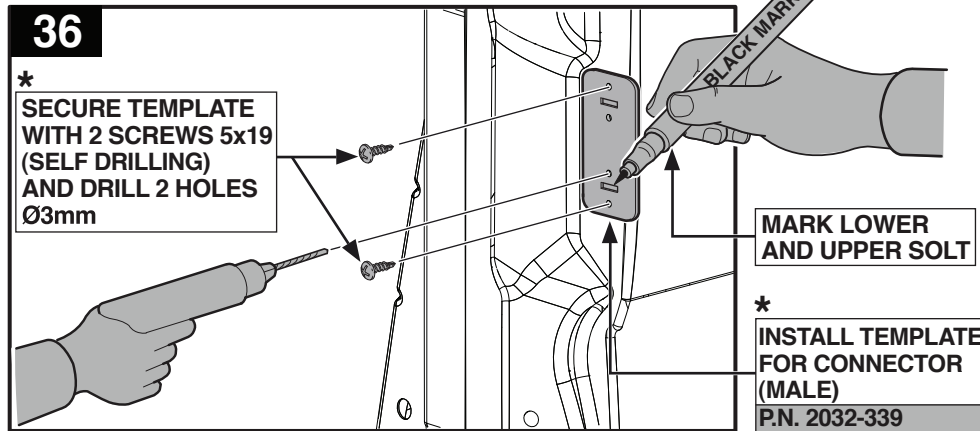

CITROEN JUMPER, DODGE PROMASTER, FIAT DUCATO, PEUGEOT BOXER  
2006-2020 / from 2021

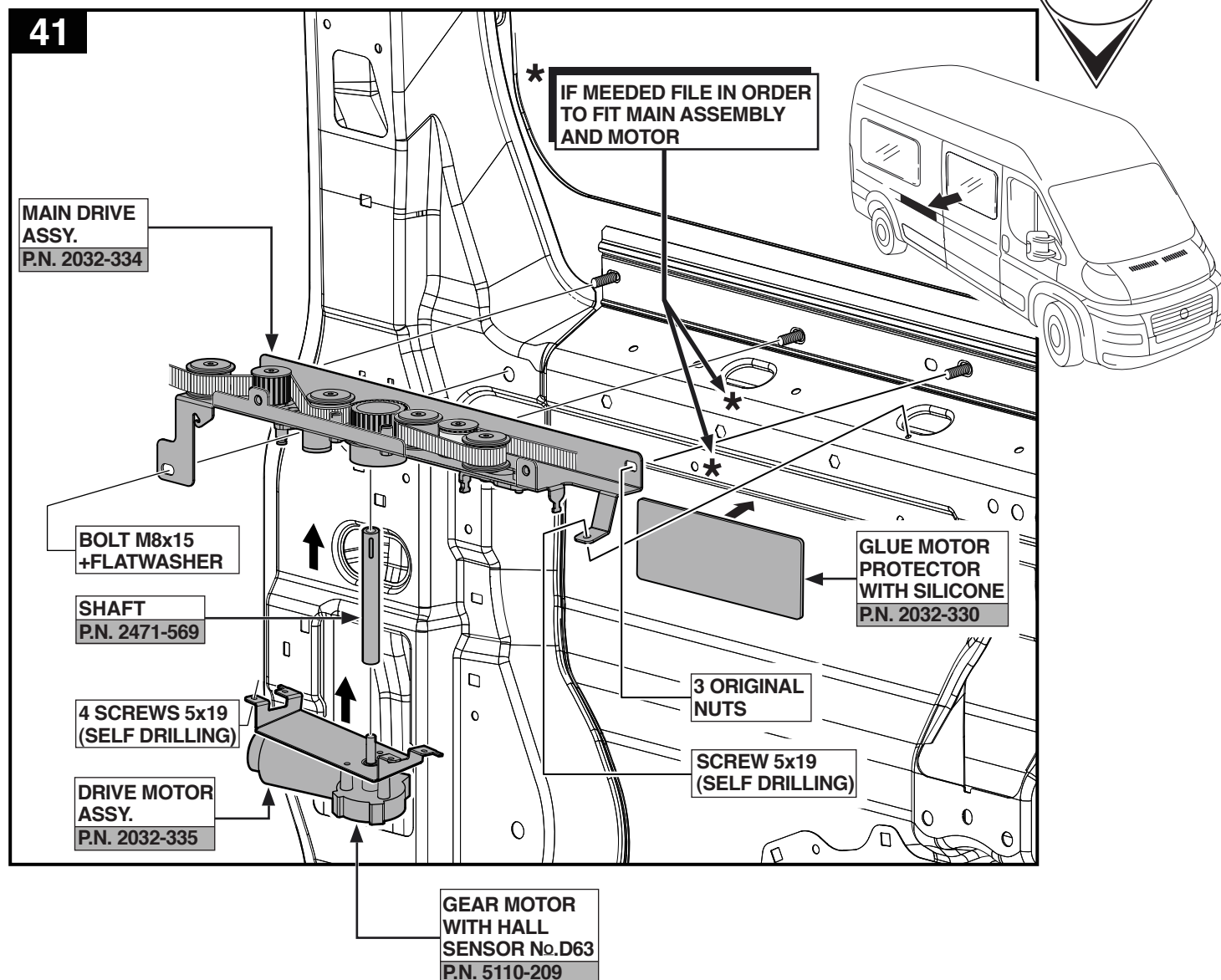

## L3 AND L4 VEHICLES

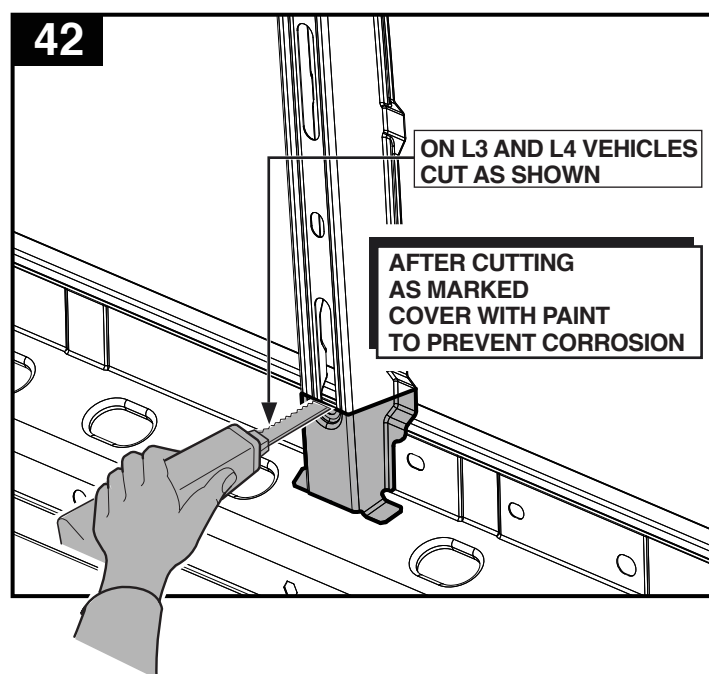

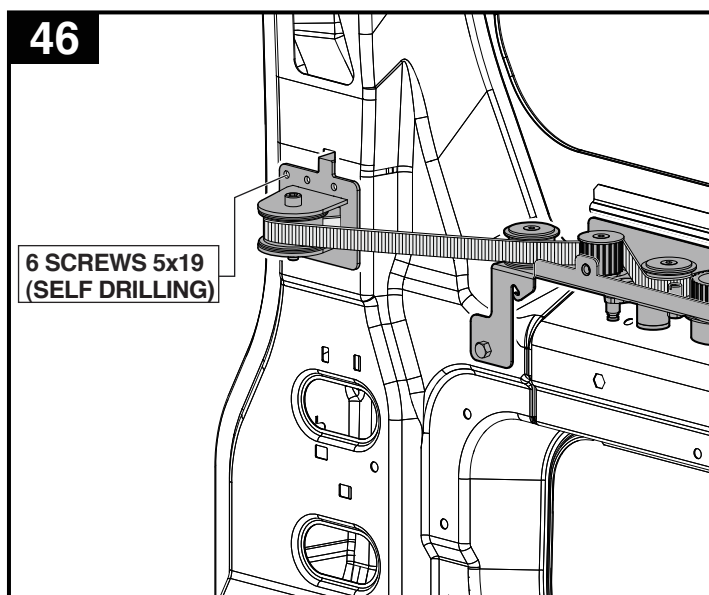
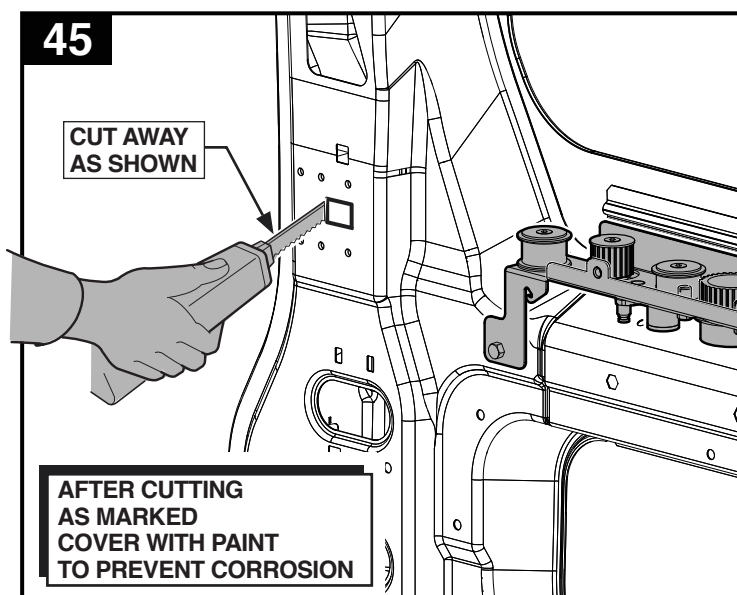
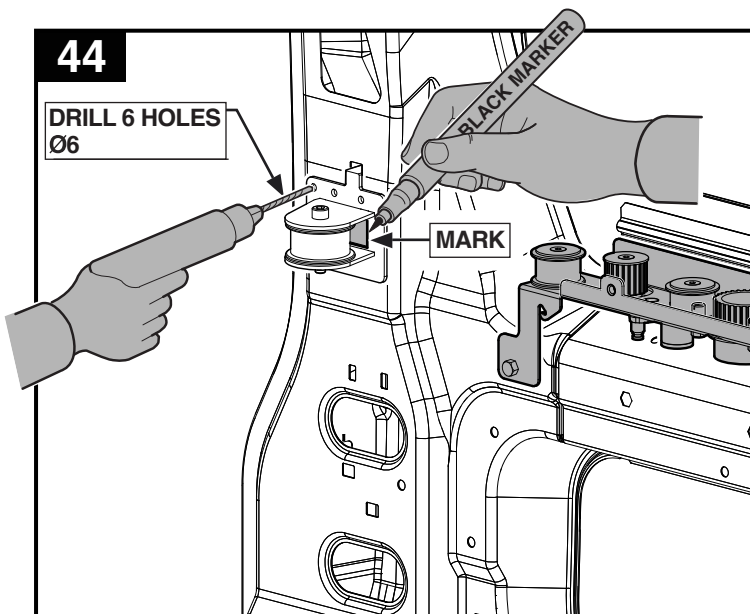
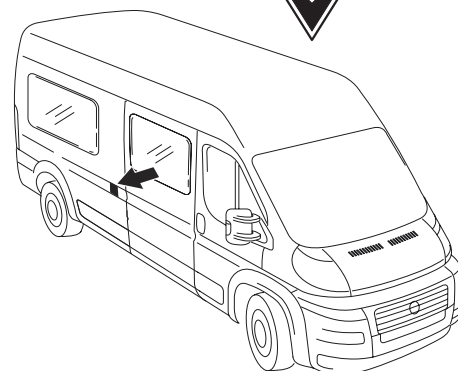
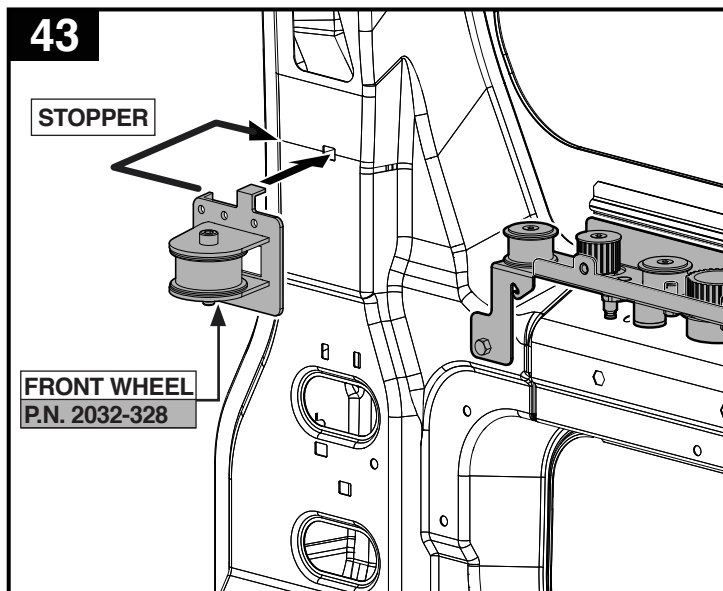

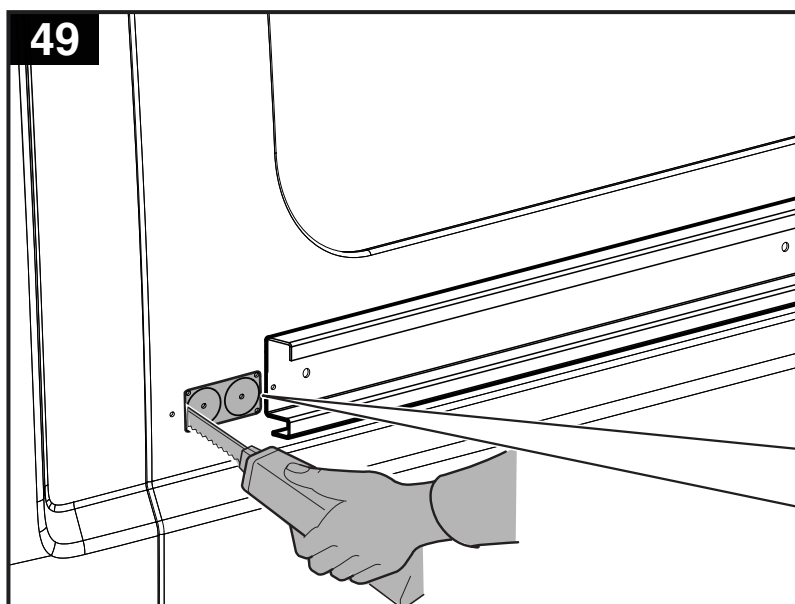
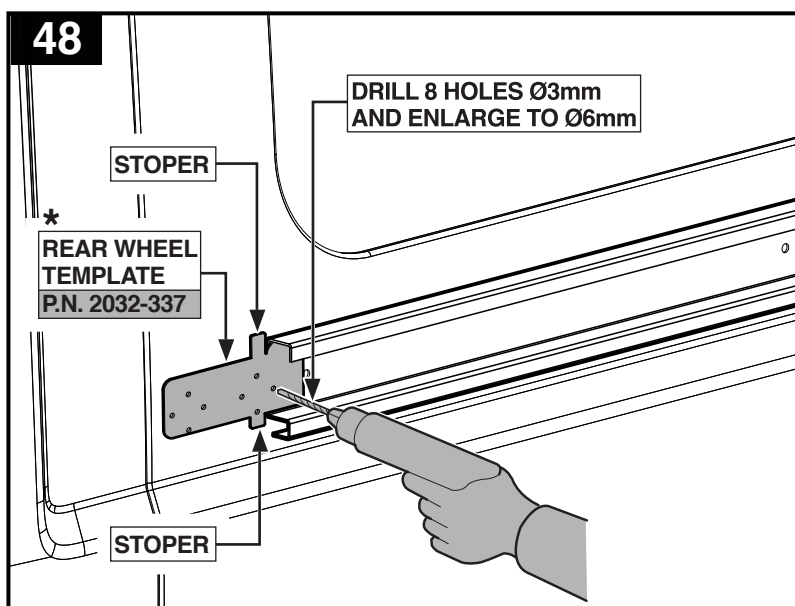
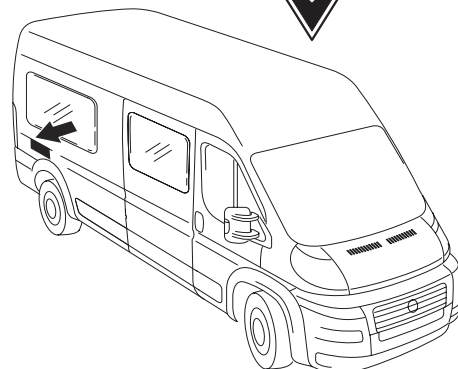
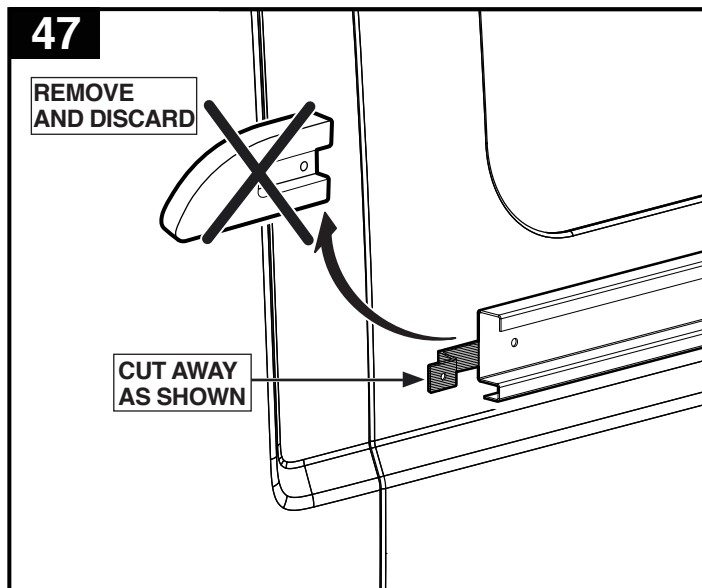

ENLARGE 2 HOLES TO Ø27mm AND CUT ACCORDING THE MARK COVER WITH PAINT TO PREVENT CORROSION

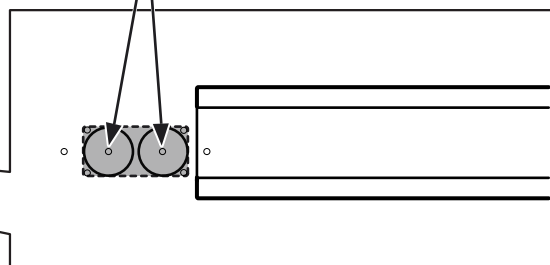



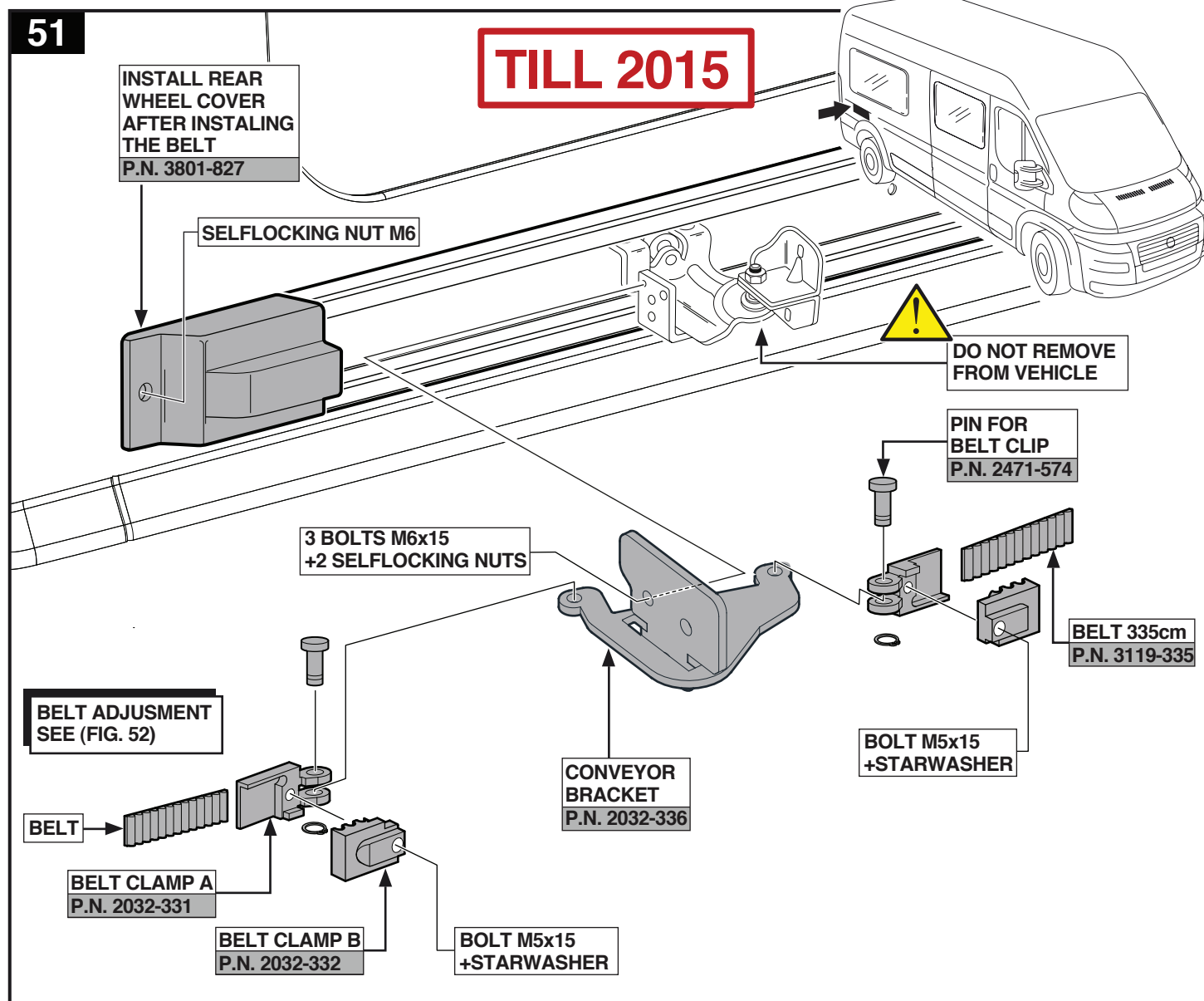
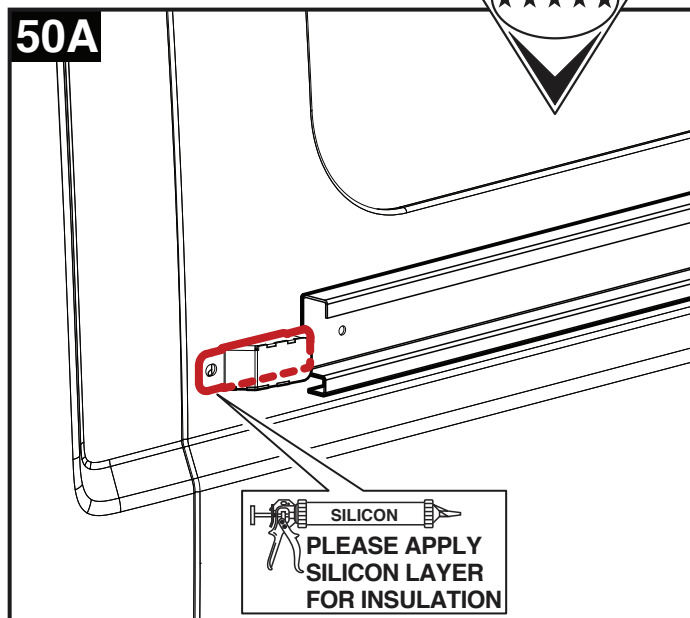
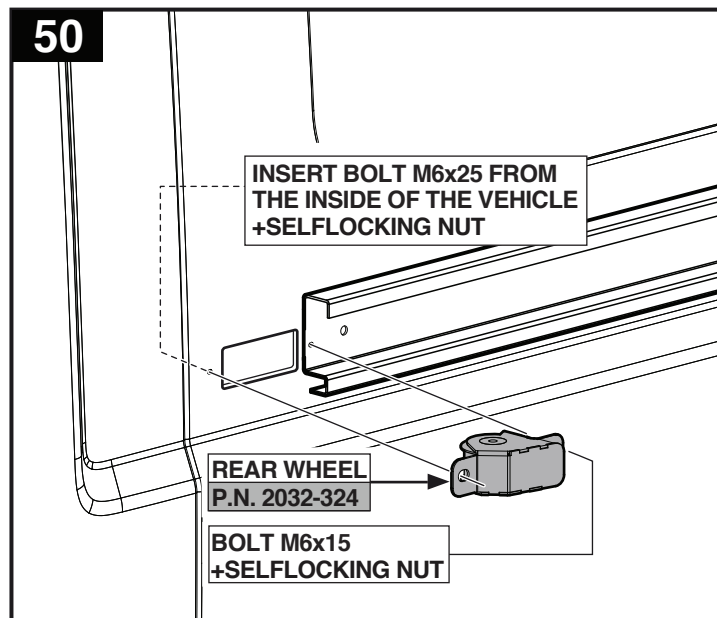



52

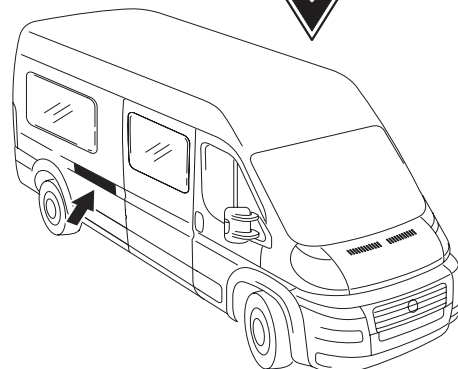
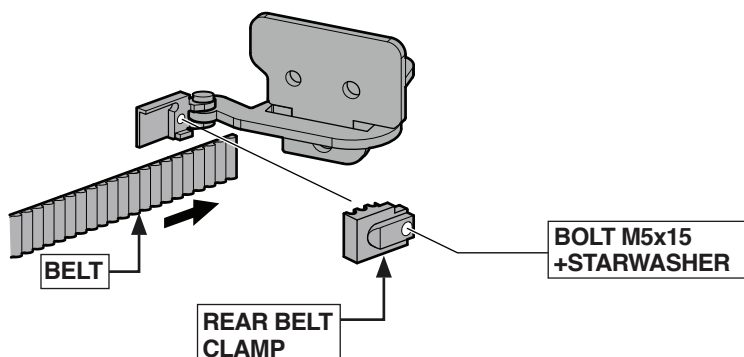

## BELT LENGTH ADJUSTMENT

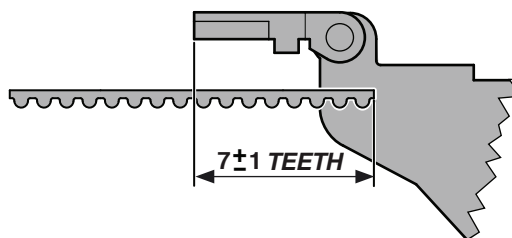

1. CLOSE THE DOOR.
2. RELEASE BELT FROM REAR BELT CLAMP.
3. STRETCH THE BELT AND CUT ACCORDING THE DRAWING, LEAVING  $7 \pm 1$  TEETH.



52A

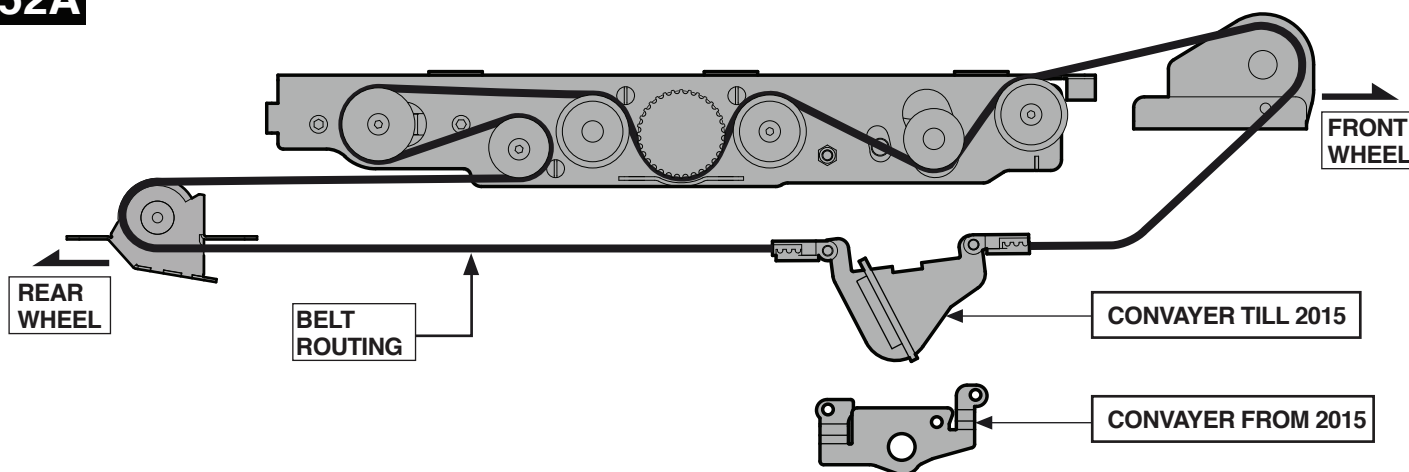

52B

**FROM 2015**

INSTALL REAR  
WHEEL COVER  
AFTER INSTALING  
THE BELT  
P.N. 3801-827

DO NOT REMOVE  
FROM VEHICLE



M6 SELFLOCKING NUT

VIEW A

PIN FOR  
BELT CLIP  
P.N. 2471-574

BELT ADJUSTMENT  
SEE (FIG. 52)

BELT 335cm  
P.N. 3119-335

BELT

BELT CLAMP A  
P.N. 2032-331

BELT CLAMP B  
P.N. 2032-332

BOLT M6x15  
+SELFLOCKING NUT M6

BOLT M5x15  
+STARWASHER

CONVEYOR  
BRACKET  
P.N. 2032-351

BOLT M5x15  
+STARWASHER

52C

DRILL Ø 6.5

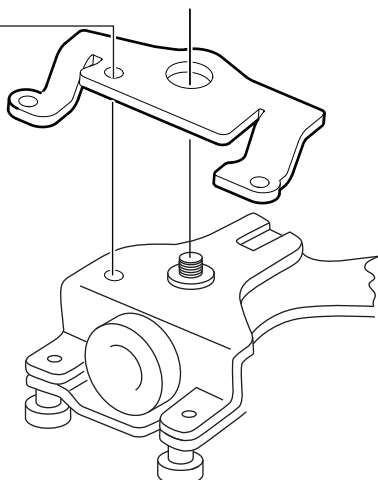

53

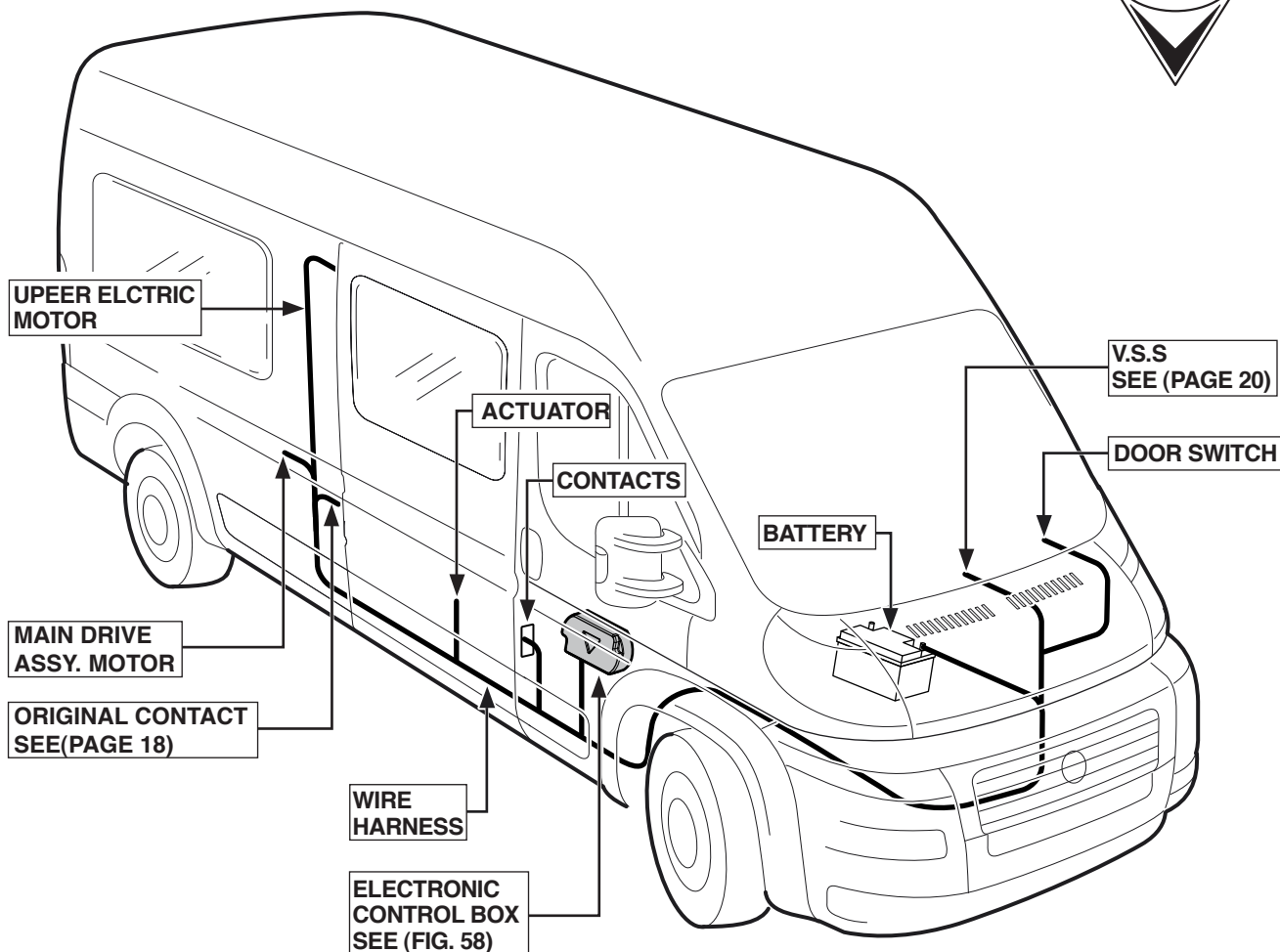

V.S.S

DRIVER FUSE BOX

54



⊕ AFTER IGNITION

55

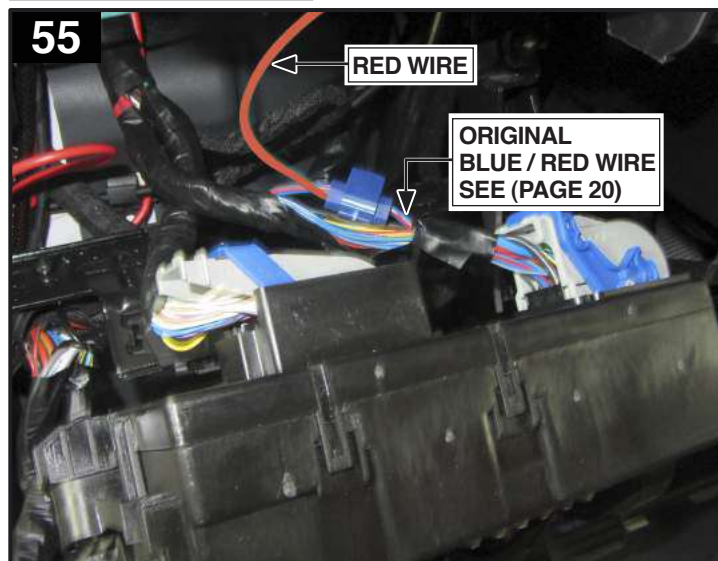



CITROEN JUMPER, DODGE PROMASTER, FIAT DUCATO, PEUGEOT BOXER  
2006-2020 / from 2021

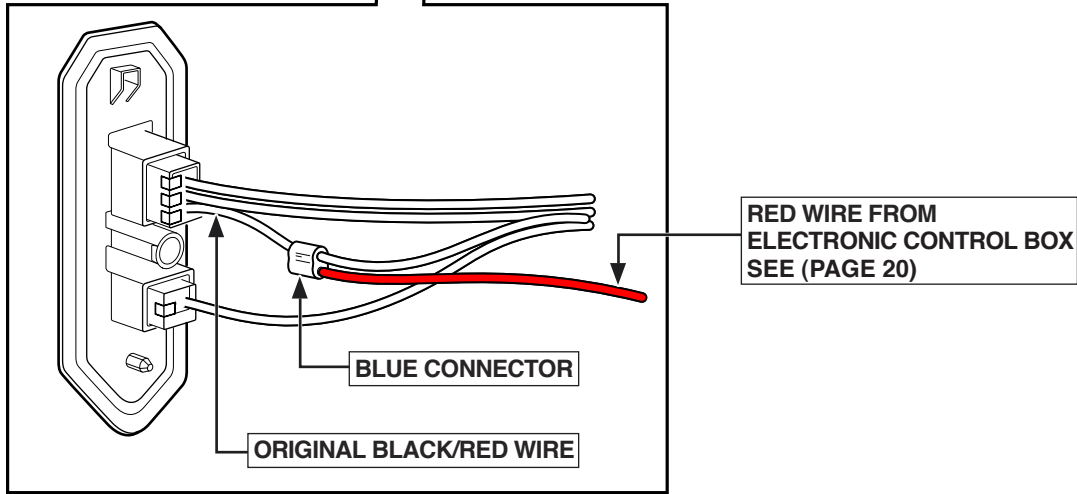
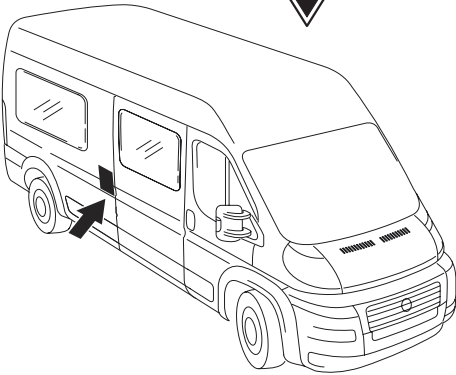
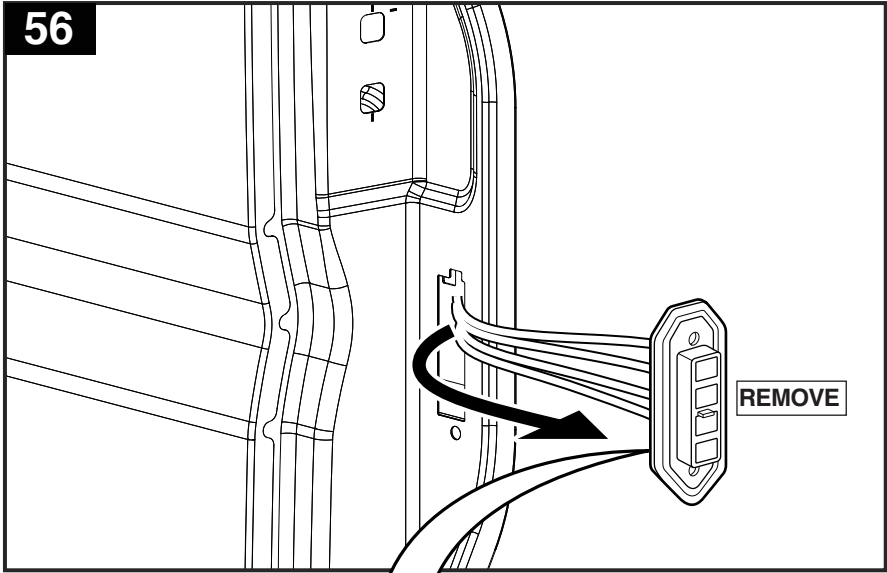



CITROEN JUMPER, DODGE PROMASTER, FIAT DUCATO, PEUGEOT BOXER  
2006-2020 / from 2021

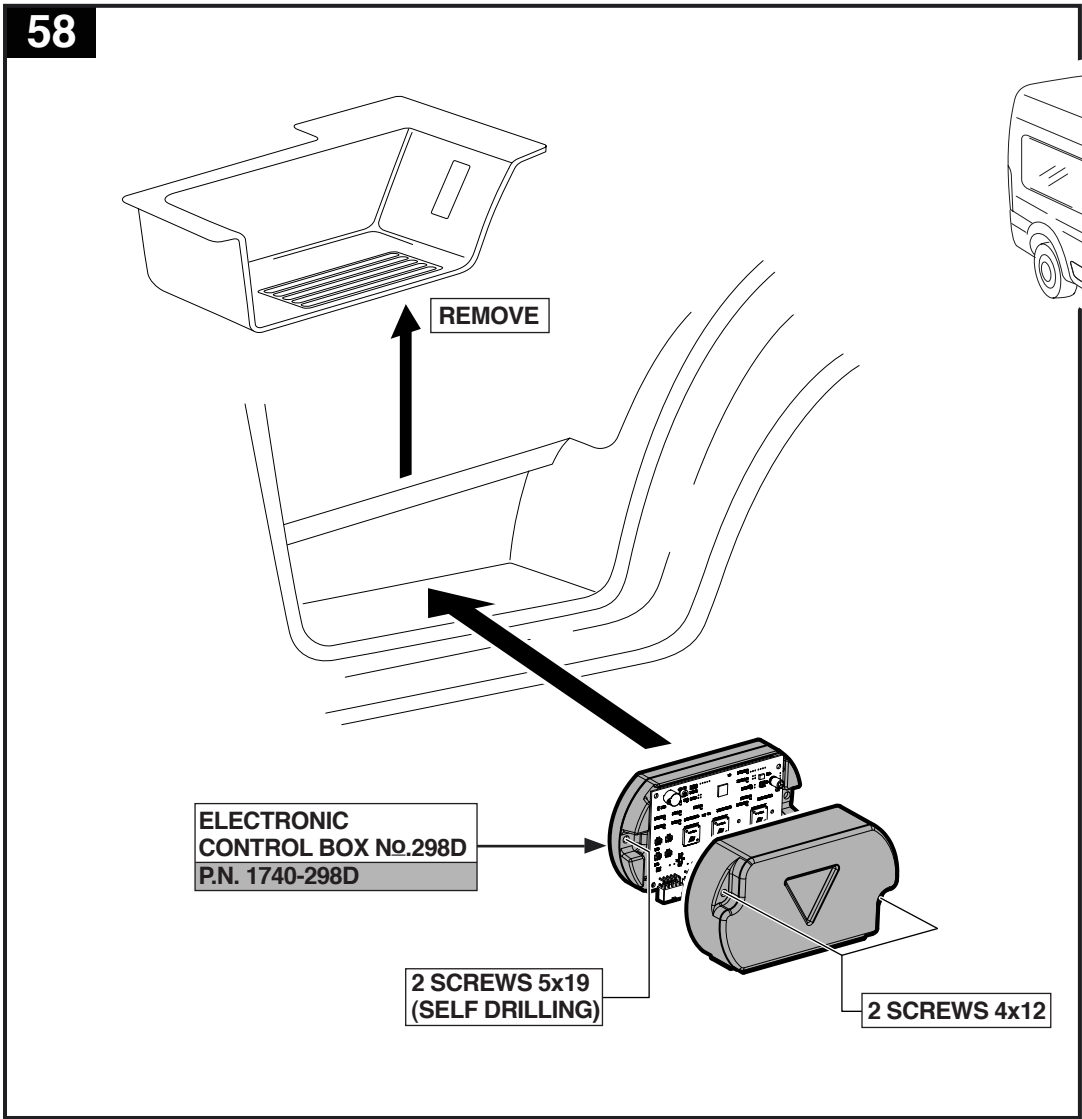
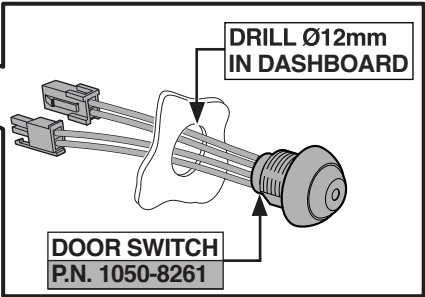



CITROEN JUMPER, DODGE PROMASTER, FIAT DUCATO, PEUGEOT BOXER  
2006-2020 / from 2021

FOR HIGH ROOF ONLY

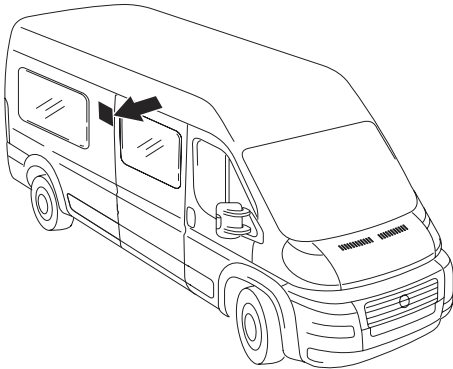
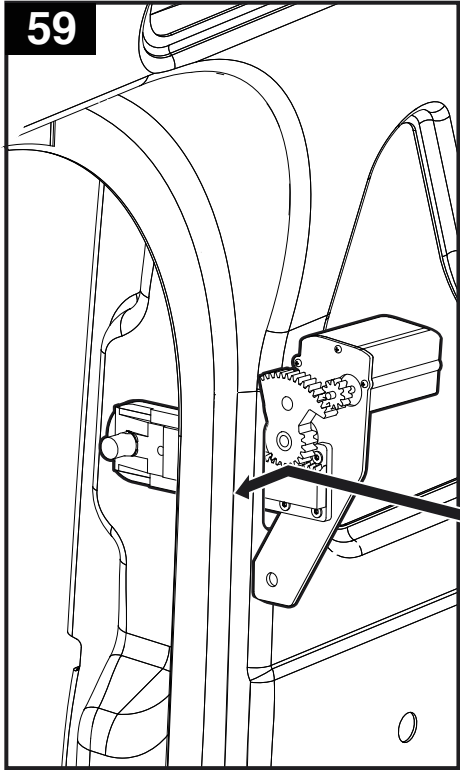

3 SCREWS 5x19  
(SELF DRILLING)

UPPER LOCK ASSY.  
SMALL PLASTIC COVER  
P.N. 3801-816



**CITROEN JUMPER, DODGE PROMASTER,  
FIAT DUCATO, PEUGEOT BOXER** **RIGHT**  
**2006-2020 / from 2021**

The photograph shows the electronic control unit (ECU) for the sliding door system. It is a green printed circuit board populated with several large electrolytic capacitors, smaller surface-mount components, and integrated circuits. Multiple multi-pin connectors are visible along the edges of the board, used for interfacing with the vehicle's electrical system and the door actuator.

# ELECTRIC SLIDING DOOR Extension

ELECTRONIC CONTROL BOX	PAGE 1-2
TROUBLESHOOTING	PAGE 3-4

\* ALEX ORIGINAL reserves the rights to make changes in our products without previous notice.



**ALEX ORIGINAL**



[info@alex-original.com](mailto:info@alex-original.com)



+972-9-8855441



16 Hamelacha St. Netanya



[www.alex-original.com](http://www.alex-original.com)



## **BASIC PROGRAMMING CLOSE / OPEN CYCLE ONCE INSTALLATION COMPLETED.**

Reprogramming Sliding Door Electronic Control Box:

(In case of belt replacement)

1. Turn off ignition key.
2. Disconnect the black connector.
3. Reconnect the black connector.
4. Turn on ignition key.
5. Press on driver's switch, the door will close with continuous beep.  
Press for the second time, the door will open with continuous beep.
6. When the door stops in open position, it is ready for use.

Potentiometer adjustment for intensity level of obstacle detection while closing.

To reduce sensitivity of Electric Door turn the Potentiometer clockwise.

To Increase sensitivity turn the Potentiometer counter clockwise .

\*Adjustment will take affect after turning ignition key off and on.

## **PROGRAMMING DOOR POSITION AT HALF WAY**

This is handy when door needs to open half way only, when a seat is located near it, for example.

As default, the module is supplied with the jumper inserted into FULL position. (J3)

For positioning the door in the HALF way mode, move Jumper out of J3 socket.

Using Original Driver Key (FOB) No Programming is needed.

## **PROGRAMMING THE REMOTE CONTROL LOCATED INSIDE THE SLIDING DOOR**

Remove jumper from its position and insert jumper into J2 on the Electronic Control Box and hold sliding door handle in open position for 3 seconds. LED will blink for confirmation.

Door handle operation: When ignition is on: Door handle operates the same way as driver switch.

When ignition is off: Door handle operates the same way as driver switch until close position.

When the door is in closed position and ignition key is off door handle operation is disabled.

Using Original Driver Key (FOB) No Programming is needed. Using Remote Controls.

Programming the Remote Control Door Operation – (In Case Original Driver Key is Not Use).

Remove jumper from its position and insert jumper into J1 socket on the Electronic Control Box and press remote for 3 seconds. LED will blink for confirmation. Repeat the process with the second remote.



## **ELECTRICAL CONNECTION (OPTION)**

A. **Electric step connection output (-) signal** for operating an ALEX ORIGINAL electric step, pin 7 at the white 10 pin connector (plug 1) to be connected to step's. Electronic Control Box.

B. **Wheel chair lift extract output (+) signal** When the door is in full opening position, output (+) signal to wheel chair lift operation, is on pin 9 at the white 10 pin connector plug.

### **C. Wheel chair lift insert door operation input (-) signal**

Input (-) will close the door when wheel chair lift is at close position.

### **D. Preventing door from closing (-) signal**

As long as there is an input (-) on pin 2, plug 3 door will not close.

## **BEEPING SOUNDS**

Learning Mode: Continuous beeping will be heard when door is at its first learning cycle.

Opening Mode: Fragmented beeping will be heard when door is opening.

Closing Mode: Fragmented beeping will be heard when door is closing.

Obstacle Detection on closing mode:

Continuous beeping will be heard.

If the sliding door is obstructed during the closing procedure, it opens fully again.

# ELECTRIC SLIDING DOOR - TROUBLESHOOTING

## OPENING MODE



- \* Key fob opens only when engine switch is on.
- \* Remote control key and door handle operates only when ignition key is on.
- \* Door can be closed once while ignition switch is off.
- \* Continuous press on driver's switch allows door to operate even if there is an obstacle

**Door opens half way** Verify jumper on electronic control box is in J3 position. If not, insert it.

Check for an obstacle or person blocking the door, check for dirt in the belt track. Reprogram door electronic control box.

**Door is not moving at constant speed**

Verify that the encoder cable (located on the electric motor side) is properly connected and not damaged. Repair if required.

Close the door and Check if problem is solved. If not, reprogram door electronic control box.

Check drive belt length and adjust it according to installation manual.

Check original rollers for a smooth operation.

**While opening the door long beep sound**

Close the door and re open it. If the problem continues:

Check the encoder connection to the electronic control box. If not, reprogram door's system.

**Door starts to open and stops** Check drive belt length and adjust it according to installation manual.

Check the cable connecting actuator to original door lock. Micro switch installed in the door should not be pressed when the door handle isn't pulled. Check door is released from lock. If not, Check contacts, release the lock.

Check for an obstacle or person blocking the door, Check for dirt in the belt track. Reprogram door electronic control box.

**Door stays locked** Check the actuator assembly and motor. Check and adjust the actuator assembly cables for opening.

Check contacts on door and on B pillar.

Verify that children's lock is unlocked.

If not set children's switch lock to unlock position. **Door doesn't opening / closing by using**

**handle option** Check micro switches and wires connections according the electric diagram. If not, reprogram door's system, remotes controls to the door PCB using Jumper J2.

### BEEPING SOUNDS

Learning Mode: Fragmented beeping will be heard when door is at its first learning cycle.

Opening Mode: Fragmented beeping will be heard when door is opening.

Closing Mode: Fragmented beeping will be heard when door is closing.

Obstacle Detection On Closing Mode: Continuous beeping will be heard.

If the sliding door is obstructed during the closing procedure, it opens fully again.



## CLOSING MODE

### ***Long beep sound While closing the door***

Open the door and re close it. If the problem continues:

Verify that the encoder cable is properly connected on both sides and not damaged.

Reprogram door electronic control box.

### ***Door will close but not lock***

Check the main and upper latch operation and adjust if needed.

Check contacts on door and on B pillar (clean).

Check the cable connecting actuator to original door lock.

### ***In closing - the door opens by its self with a long beeping***

Check if there is an obstacle or person blocking the door, check for dirt in the belt track.

Check drive belt length and adjust it according to installation manual.

\*\*\* If problem continues, adjust the potentiometer as per installation manual (turn the potentiometer clock-wise).

### ***Door is not moving at constant speed***

Verify that the encoder cable is properly connected on both sides and not damaged. Repair as required.

Close and open the door and check if problem is solved. If not, reprogram door electronic control box

Check drive belt length and adjust it according to installation manual.

\*\*\* If problem continues, adjust the potentiometer as per installation manual (turn the potentiometer clock-wise).

## REMOTE CONTROL AND BUTTONS

### ***Remote control doesn't operate***

Remote control operates only when ignition key is off. Check remote control's batteries. Replace if needed.

Verify that the remote is programmed To the electric control box and reprogram if needed.

For vehicles with original remote control (as Sprinter / Crafter / Transit / Ducato, etc):

Check if central locking signal wire is connected to electronic control box pin 4 plug 3.

### ***Dash button doesn't operate***

Driver button operates only when ignition key is on.

Check connections (+) after ignition.

Check if the LED in the driver button is on when the door is closed and flashing when the door is open.

While pressing dash button Check output single on the button white wire to electronic control box.

***Door handle operation*** Door handle operates only when ignition key is on.

Micro switch installed in door should not be pressed when the door handle isn't pulled.

Check micro switch remote control's batteries, replace if needed.

Reprogram door handle remote control to electronic control box (J2).

### ***Door does not work at all from dash switch and the remote control***

Check fuse of the door system.

Check the battery voltage on the electronic control box main supply plug.

### ***VSS signal = door is not closing automatically when the vehicle starts moving on the road***

Check if the VSS signal option is connected correctly to the original cantus / wires of the vehicle.

if there is no connection to the original speed of the vehicle, please use ALEX ORIGINAL VSS print P.N. 1740-001.

### ***Others***

Check the belt for damage.

Check the belt's length.

If needed, readjust the belt for 6-7 teeth (as per installation manual).

#### ONLINE

(E-mail) [info@alex-original.com](mailto:info@alex-original.com)

(Web) [www.alex-original.com](http://www.alex-original.com)

#### CONTACT

(Phone) +972-9-8855441

(Fax) +972-9-8855442

#### ADDRESS

16 Hamelacha St., P.O.BOX 8521,  
Netanya. 4250551 Israel